

4TH Greater Philadelphia Regional Convention

*Together
We Grow*



April 4, 5, 6

PHILADELPHIA CENTRE HOTEL

1725 Kennedy Blvd. Phila., PA

Telephone: 215-568-3300

Hotel Rates Per Night

SINGLE/DOUBLE	\$ 40.00
TRIPLE	\$ 45.00
QUAD	\$ 50.00



Payable To: GPRC-NA P.O. Box 940 King of Prussia, PA 19406

Registration \$10.00 < >

NAME _____

Banquet \$20.00 < >

Address _____

Sirloin dinner



Sunday brunch \$12.00 < >

cut-off date: 3/15 (no refunds)

Total Package in Advance \$40.00 < >

For More Info. Call: Steve -215-925-7766 Sheryl-215-624-8516

4 Greater Philadelphia Regional Convention

*Together
We Grow*



April 4, 5, 6

THE TWELVE STEPS

1. We admitted that we were powerless over our addiction, that our lives had become unmanageable.
2. We came to believe that a power greater than ourselves could restore us to sanity.
3. We made a decision to turn our will and our lives over to the care to God as we understood Him.
4. We made a searching and fearless moral inventory of ourselves.
5. We admitted to God, to ourselves, and to another human being the exact nature of our wrongs.
6. We were entirely ready to have God remove all these defects of character.
7. We humbly asked Him to remove our shortcomings.
8. We made a list of all persons we had harmed, and became willing to make amends to them all.
9. We made direct amends to such people wherever possible, except when to do so would injure them or others.
10. We continued to take personal inventory, and when we were wrong promptly admitted it.
11. We sought through prayer and meditation to improve our conscious contact with God, as we understood Him, praying only for knowledge of His will for us, and the power to carry that out.
12. Having had a spiritual awakening as a result of those steps, we tried to carry this message to addicts and to practice these principles in all our affairs.

Welcome



G.P.R.C.-N.A.

"TOGETHER WE GROW"

The Greater Philadelphia Regional Convention Committee of Narcotics Anonymous would like to welcome you to the 4th Regional Convention. This year's theme is "Together We Grow". Our first tradition concerns unity and our common welfare. One of the most important things about our new way of life is being a part of a group of addicts seeking recovery. Our survival is directly related to the survival of the group and fellowship.

Not only are there common themes in our addiction, but we find that in our recovery we have much in common. We share a common desire to stay clean, and in the spirit of this fellowship we can truly grow together.

The GPRCNA Hospitality Suite is located in Room 524, which will be open Friday 6 p.m. till Sunday 10 a.m. NAR-ANON will have an information center located in Room 534, which will be open also Friday 6 p.m. till Sunday 10 a.m. Anyone with merchandise for sale must report to the store clerk in the Delaware Valley Suite on the third floor. Name tags must be worn for admittance to all functions.

We would ask everyone to be responsible to uphold the good reputation of N.A. for future conventions.

In the spirit of love and service — 4th GPRCNA

NO ADDICT SEEKING RECOVERY NEED EVER DIE



FRIDAY April 4, 1987

REGISTRATION 2 p.m. — on 3rd Floor Registration Area

MARATHON MEETING BEGINS 3 p.m. Room 540 / 546

OPEN MEETING
7:00 P.M.

READERS
*Tommy S.
Michelle P.
Steve L.
Charlie C.
Colleen J.*

GRAND BALLROOM

CHAIR
Bill R.

SPEAKERS
*Patty C. (Phila.)
Peter L. (Conn.)*

DANCE 10:00 p.m. — 2:00 a.m.

GRAND BALLROOM

SATURDAY APRIL 5, 1986

TIME	FUNCTION	LOCATION
9 a.m.-5 p.m.	REGISTRATION	3rd Fl Reg. Area
9:15-10:30	4th STEP WORKSHOP CHAIR: <i>Mitchell G.</i> SPEAKER: <i>Liz M.</i>	CONSTITUTION ROOM 3rd Floor
9:15-10:30	LIFE ON LIFE'S TERMS CHAIR: <i>Steve L.</i> SPEAKER: <i>Steve J.</i>	INDEPENDENCE ROOM 3rd Floor
9:15-10:30	PRINCIPLES BEFORE PERSONALITIES CHAIR: <i>Dennis N.</i> SPEAKER: <i>Jim D.</i>	CAFE CAREME 2nd Floor
10:00-11:30	HOTLINE WORKSHOP	Room 548/554
10:45-12:00	SELF-OBSESSION CHAIR: <i>Michelle P.</i> SPEAKER: <i>Kurt E.</i>	CONSTITUTION ROOM 3rd Floor
10:45-12:00	RECOVERY & RELAPSE CHAIR: <i>J.R.</i> SPEAKER: <i>Dave M.</i>	INDEPENDENCE ROOM 3rd Floor

TIME	FUNCTION	LOCATION
10:45-12:00	BEGINNERS MEETING CHAIR: <i>Steve S.</i> SPEAKER: <i>Rodney</i>	CAFE CAREME 2nd Floor
12:00-1:45 p.m.	H & I WORKSHOP	Room 548/554
12:15-1:30	SPONSORSHIP CHAIR: <i>Chris D.</i> SPEAKER: <i>Kathy D.</i>	CONSTITUTION ROOM 3rd Floor
12:15-1:30	JAILS, INST. & RECOVERY CHAIR: <i>Charlie C.</i> SPEAKER: <i>Dennis D.</i>	INDEPENDENCE ROOM 3rd Floor
12:15-1:30	RELATIONSHIPS CHAIR: <i>Pam B.</i> SPEAKER: <i>Randy J.</i>	CAFE CAREME 2nd Floor
2:30-4:15	MEN'S MEETING CHAIR: <i>Kenton L.</i> SPEAKER: <i>Kenny E.</i>	CONSTITUTION ROOM 3rd Floor
2:30-4:15	GAY MEETING CHAIR: <i>Kathy L.</i> SPEAKER: <i>Bruce</i>	INDEPENDENCE ROOM 3rd Floor
2:30-4:15	WOMEN'S MEETING CHAIR: <i>Sheryl R.</i> SPEAKER: <i>Sharon B.</i>	CAFE CAREME 2nd Floor

BANQUET

GRAND BALLROOM

6:00 p.m.

OPENING PRAYER: *Billy Z. (Md.)*

DINNER

READERS

Kenton L., Chris D., Bob B., Bill R., J.R.

CHAIR

Mitchell S.

ANNIVERSARIES

Steve S.

AREA RECOGNITION

Steve L.

CLEAN TIME COUNTDOWN

Sheryl R.

"YOU CAN'T KEEP WHAT YOU HAVE UNLESS YOU GIVE IT AWAY"

Mary M.

SPEAKER

Marty E. (Md.)

DANCE

GRAND BALLROOM

10:00 p.m. — 2:00 a.m.

SUNDAY APRIL 6, 1986

BREAKFAST

PENNSYLVANIA BALLROOM

3rd Floor

8:00 a.m. — 10:00 a.m.

SPIRITUAL MEETING

PENNSYLVANIA BALLROOM

READERS

Jennifer R., John D., Mitchell G., Liz M., Alan C.

CHAIR

Bob B.

SPEAKERS

Tommy C. (Phila.)

Rosie (NYC)

Closing

THANK YOU ONE AND ALL FOR YOUR PARTICIPATION

And A Special Thanks



TO THE HOTEL STAFF, CONVENTION COMMITTEE, AND ESPECIALLY OUR HIGHER POWER.

JUST FOR TODAY

Tell yourself —

JUST FOR TODAY my thoughts will be on my recovery, living and enjoying life without the use of drugs.

JUST FOR TODAY I will have faith in someone in N.A. **WHO BELIEVES IN ME AND WANTS TO HELP ME IN MY RECOVERY.**

JUST FOR TODAY I will have a program. I will try to follow it to the best of my ability.

JUST FOR TODAY through N.A. I will try to get a better perspective on my life.

JUST FOR TODAY I will be unafraid, my thoughts will be on my new associations, people who are not using and who have found a new way of life. So long as I follow that way, I have nothing to fear.

THE TWELVE TRADITIONS

1. Our common welfare should come first; personal recovery depends on N.A. unity.
2. For our Group purpose there is but one ultimate authority—a loving God as He may express Himself in our Group conscience; our leaders are but trusted servants, they do not govern.
3. The only requirement for membership is a desire to stop using.
4. Each Group should be autonomous, except in matters affecting other Groups, or N.A., as a whole.
5. Each Group has but one primary purpose—to carry the message to the addict who still suffers.
6. An N.A. Group ought never endorse, finance, or lend the N.A. name to any related facility or outside enterprise, lest problems of money, property or prestige divert us from our primary purpose.
7. Every N.A. Group ought to be fully self-supporting, declining outside contributions.
8. Narcotics Anonymous should remain forever non-professional, but our Service Centers may employ special workers.
9. N.A., as such, ought never be organized; but we may create service boards or committees directly responsible to those they serve.
10. N.A. has no opinion on outside issues; hence the N.A. name ought never be drawn into public controversy.
11. Our public relations policy is based on attraction rather than promotion; we need always maintain personal anonymity at the level of press, radio, and films.
12. Anonymity is the spiritual foundation of all our Traditions, ever reminding us to place principles before personalities.

The Serenity Prayer

God grant me the
Serenity to accept the things
I cannot change;

Courage to change the things I
can; and
Wisdom to know the difference.

Living one day at a time;
enjoying one moment at a time;
Accepting hardship
as the pathway to peace;

Taking, as He did, this sinful
world as it is, not as I would
have it;

Trusting that He will make all
things right if I surrender
to His will;

That I may be reasonably happy
in this life, and supremely
happy with Him forever in
the next. Amen.

Reinhold Niebuhr



FREEDOM

MARATHON MEETING GPRCNA4

CHAIR SPEAKER TOPIC

FRIDAY ROOM 546/540

3:00 P.M.	STEVE S.		OPEN DISCUSSION
4:00 P.M.	MITCHELL G.		OPEN DISCUSSION
5:00 P.M.	ALAN C.		OPEN DISCUSSION
6:00 P.M.	ROB U.	BARBARA B.	SPEAKER DISCUSSION
7:00 P.M.	JERRY MC.		OPEN DISCUSSION
8:00 P.M.	MARLENE O.		OPEN DISCUSSION
9:00 P.M.	JOE C.		OPEN DISCUSSION
10:00 P.M.	JEFF M.	COLLEEN M.	<u>THE FIRST STEP</u>
11:00 P.M.	SCOTT S.		OPEN DISCUSSION

SATURDAY

12:00 A.M.	KENNY S.	RICK D.	SPEAKER DISCUSSION
1:00 A.M.	JIMMY K.		OPEN DISCUSSION
2:00 A.M.	JIMMY D.	JOE G.	<u>SECOND STEP</u>
3:00 A.M.	DAVE H.		OPEN DISCUSSION
4:00 A.M.	SHERYL R.	FRANK C.	<u>THIRD STEP</u>
5:00 A.M.	STEVE S.		OPEN DISCUSSION
6:00 A.M.	STEVE J.		OPEN DISCUSSION
7:00 A.M.	CONNIE R.		OPEN DISCUSSION
8:00 A.M.	DIANE W.		OPEN DISCUSSION

Together
We Grow



4TH GPRC-NA

APRIL 4 5 6



Together
We Grow

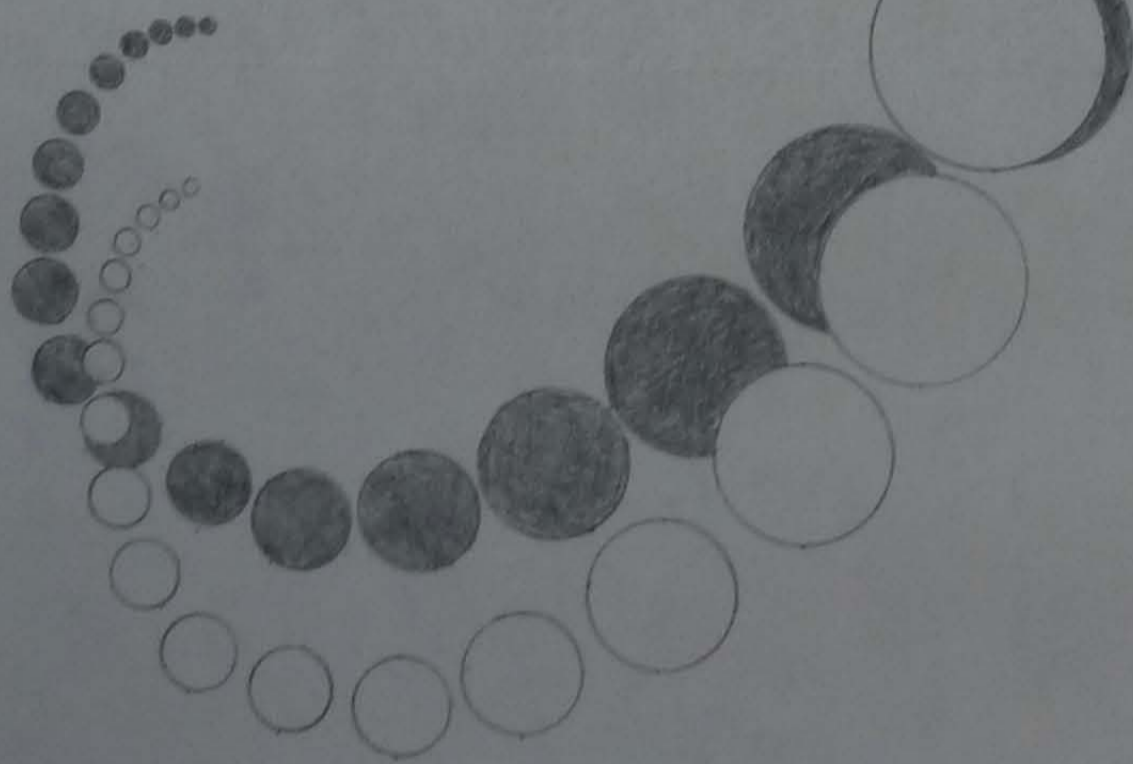

4th G.P.R.C.-NAGC

Together We Grow

4th G.P.R.C.-NA

FRIDAY NIGHT

DANCE

10 P.M.

SATURDAY
NIGHT

DANCE

S A T U R D A Y

B a n q u e t

G P R C N A 4

S U N D A Y

B R E A K F A S T

G P R C N A 4



*22 ml + Chestnut
May 9 June 13 July 11
23 - Phila. 20 18
27 25*

GPRC-NA
P.O. Box 940
King of Prussia
Phila., PA 19101

March 13, 1986

TO ALL OF OUR N/A MEMBERS:

We hope you have heard about our annual Greater Philadelphia Regional Convention. It's coming up on April 4,5, and 6 and we want you to be there.

The convention is being held this year at the Centre Hotel, 17th and JFK Blvd., Philadelphia, PA. There are meetings and workshops scheduled around the clock with speakers from all over the country. Saturday night we are having a banquet and dance. Please don't miss it.

Registration for the convention will be open until April 2. It costs \$10.00 to register for the weekend and \$20.00 if you would like to attend the banquet. Also \$12.00 for a Sunday buffet. Hotel registration must be made separately by calling (215) 568-3300. Hotel rates are printed on the enclosed registration flyers.

If you have not registered please do so soon. Payment can be made to GPRC-NA, P.O. Box 940, King of Prussia, PA 19406. Our theme this year is "Together We Grow", and we need you to make it happen.

Sincerely,

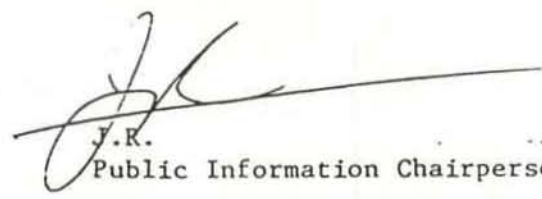
J.R.
Public Information Chairperson

MEETING FORMAT

I WOULD LIKE TO WELCOME EVERYONE TO THE GPRCNA #4 WOMEN'S MEETING. MY NAME IS _____ AND I AM AN ADDICT.

- 1) BEGIN WITH THE SERENITY PRAYER.
- 2) CHAIRPERSON ASSIGNS 4 READERS TO READ AT THE MICROPHONE OR PODIUM.
 - A) WHO IS AN ADDICT?
 - B) WHAT IS NA?
 - C) HOW IT WORKS
 - D) TWELVE TRADITIONS
- 3) INTRODUCE SPEAKER (TO SHARE 30 TO 50 MINUTES)
- 4) WHEN SPEAKER IS FINISHED - CHAIRPERSON TAKES BACK MEETING AND REMINDS EVERYONE TO KEEP THEIR SHARING DOWN TO 5 MINUTES OR LESS TO ALLOW AS MANY AS POSSIBLE THE CHANCE TO SHARE. ENCOURAGE PEOPLE TO COME UP FRONT TO THE MICROPHONE OR PODIUM, SO EVERYONE WILL BE ABLE TO HEAR THEM.
- 5) CHAIRPERSON GIVES MEETING BACK TO SPEAKER.
- 6) SPEAKER TURNS MEETING BACK TO CHAIRPERSON 5 MINUTES BEFORE THE END OF MEETING FOR CLOSING.
- 7) CHAIRPERSON MAY SHARE - CLOSE MEETING BY READING THE FOLLOWING:

ANONYMITY IS THE SPIRITUAL FOUNDATION OF ALL OUR TRADITIONS, EVER REMINDING US TO PLACE PRINCIPLES BEFORE PERSONALITIES.

WE FEEL THAT OUR APPROACH TO THE PROBLEM OF ADDICTION IS COMPLETELY REALISTIC, FOR THE THERAPEUTIC VALUE OF ONE ADDICT HELPING ANOTHER IS WITHOUT PARALLEL.

AS LONG AS THE TIES THAT BIND US TOGETHER ARE STRONGER THAN THOSE THAT WOULD TEAR US APART - ALL WILL BE WELL.
- 8) WE HAVE A NICE WAY OF CLOSING:
 - A) MOMENT OF SILENCE FOR THE SUFFERING ADDICT.
 - B) LORD'S PRAYER.

I WOULD LIKE TO WELCOME EVERYBODY TO THE SPIRITUAL MEETING
OF THEFOURTH GREATER PHILADELPHIA CONVENTION, MYMNAME IS
BOBBY AND I AM AN ADDICT.

ASK **EVERYONE** TO JOIN IN THE SERENITY PRAYER.

WHO ~~JENNIFER R.~~
WHAT ~~S.~~
HOW MITCHELL G.
PART 2 LIZ M.
12 TRADITIONS ALAN C.

ANNOUNCEMENTS

INTRODUCE SPEAKERS

TOMMY C. PHILA.

ROSIE NYC

please read the following

Together We Grow



4th G.P.R.C. - NA

*addresses
'n phones*

NAME AND ADDRESS		TELEPHONE	A B C D E F G H I J K L M N O P Q R S T U V W X Y Z
2002 A ST		AREA CODE	
2003 A ST		NUMBER	
2004 A ST		AREA CODE	
2005 A ST		NUMBER	
2006 A ST		AREA CODE	
2007 A ST		NUMBER	
2008 A ST		AREA CODE	
2009 A ST		NUMBER	
2010 A ST		AREA CODE	
2011 A ST		NUMBER	
2012 A ST		AREA CODE	
2013 A ST		NUMBER	

THE GREATER PHILADELPHIA REGIONAL

CONVENTION COMMITTEE PRESENTS...

A ROLLER SKATING PARTY!

*** MIDNIGHT
TILL
3 AM.**



*** ADMISSION -
\$4.00
+
SKATE RENTAL -
\$1.00**

SATURDAY, FEBRUARY 15TH 86

KENSINGTON ROLLER RINK

KENSINGTON & ONTARIO STREETS

NORTHEAST PHILADELPHIA

(one block from the TIOGA el stop)

"COME &

TRY TO BOGGIE ON WHEELS!"



*Together
We Grow*



4th G.P.R.C.-NFA

April 4, 5, 6

*Together
We Grow*



4th G.P.R.C.-NFA

April 4, 5, 6

BOGGIE AT THE BOATHOUSE !

DON'T MISS
THE LAST
FUNDRAISER....
BEFORE THE
CONVENTION!



*ADMISSION -
\$5.00



*9:30 PM
TILL
1:30 AM

INTENSE
EXCITEMENT !

SATURDAY, MARCH 29TH
BOATHOUSE #2 - the FAIRMOUNT
EAST RIVER DRIVE
PHILADELPHIA

***SPONSORED** by the
GPRC - NA

In Philadelphia
business centers around us.

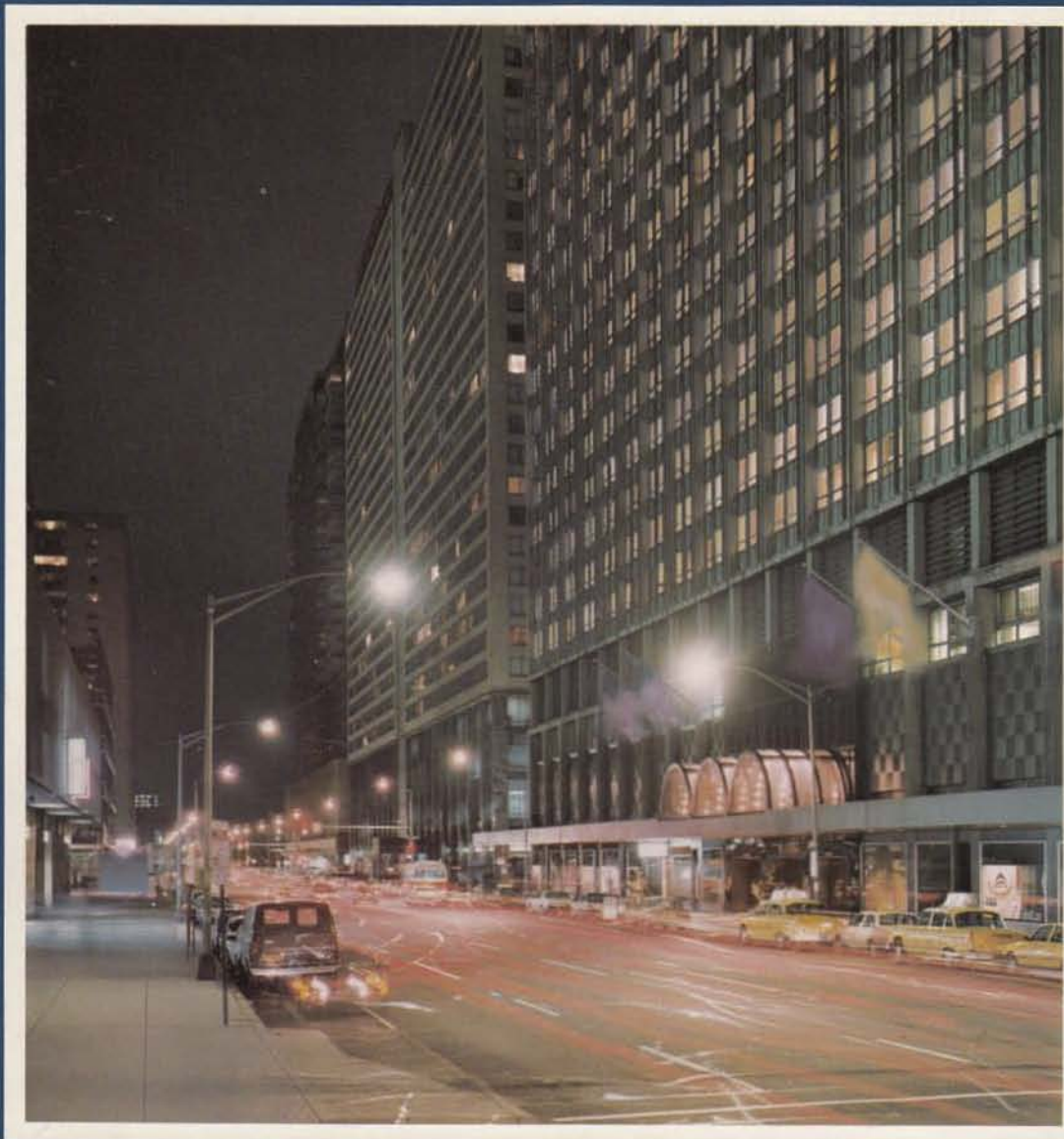

The
PHILADELPHIA
CENTRE HOTEL

A Tollman-Hundley Hotel



1725 John F. Kennedy Boulevard, Philadelphia, Pennsylvania 19103 • (215) 568-3300

Meet at the heart of Penn Center, Philadelphia's business headquarters

You can't find a better business location in Philadelphia. You're within walking distance of Centre Square and all of the Penn Center office buildings, City Hall, the shops of Chestnut and Walnut Streets and some of the best restaurants in the country.

And inside the hotel, you'll find 30 meeting rooms. We can accommodate your group of 15 or 1500. And our expert staff is on hand to make your meeting the most efficient ever.



Cafe Careme

The PHILADELPHIA CENTRE HOTEL



Grand Ballroom

A modern hotel with first-class amenities



Lobby



Amelia's Cocktail Lounge



Guest Room



Over 60 Hospitality Suites in various sizes are available.

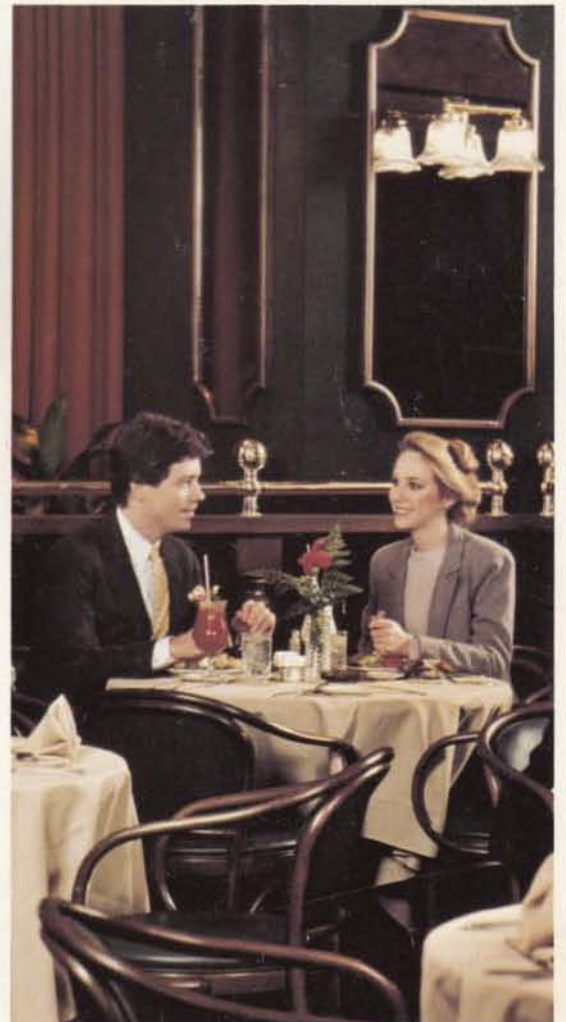

Crossroads Restaurant

Second Floor

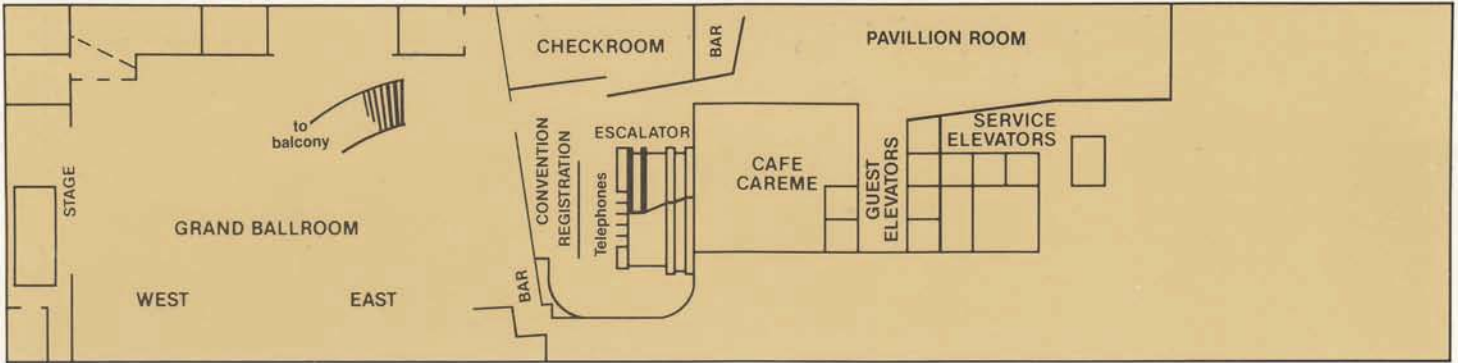

Third Floor

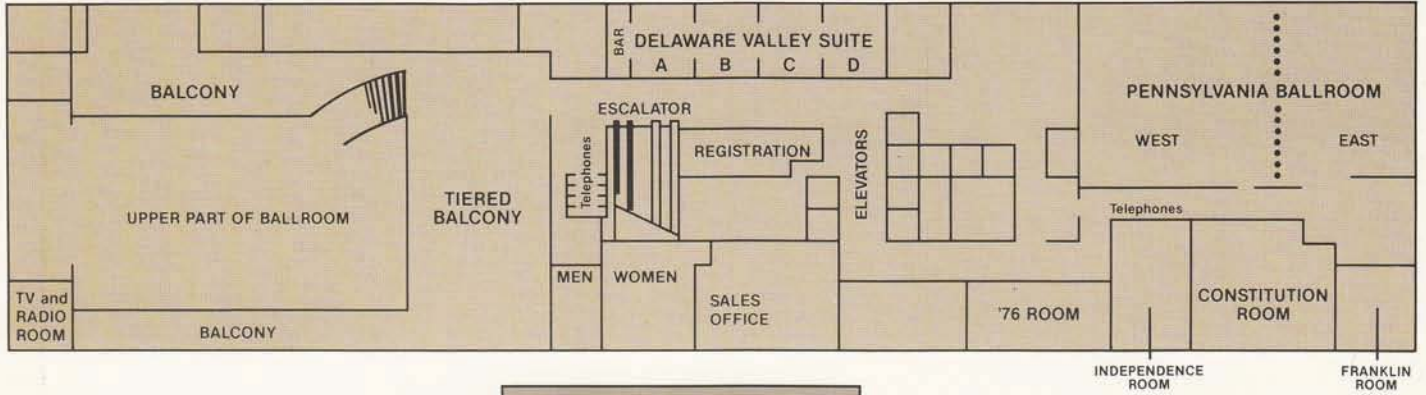

Fifth Floor

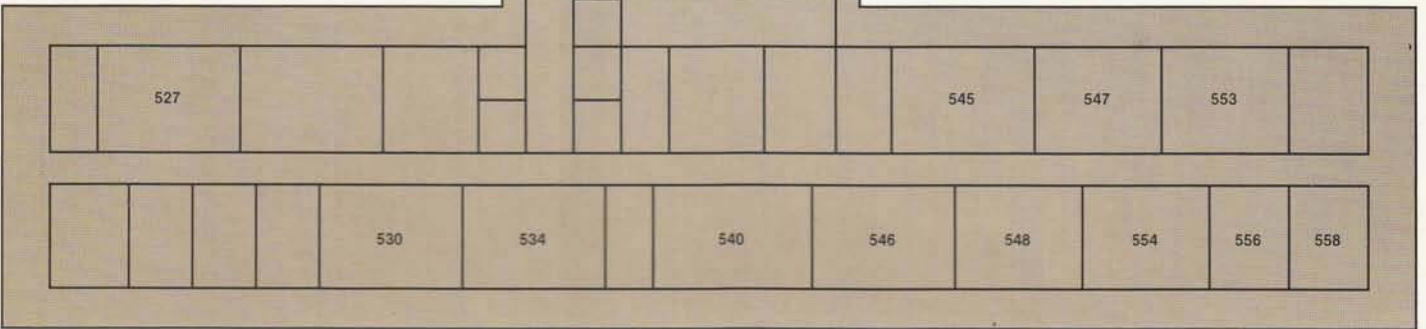

Concourse

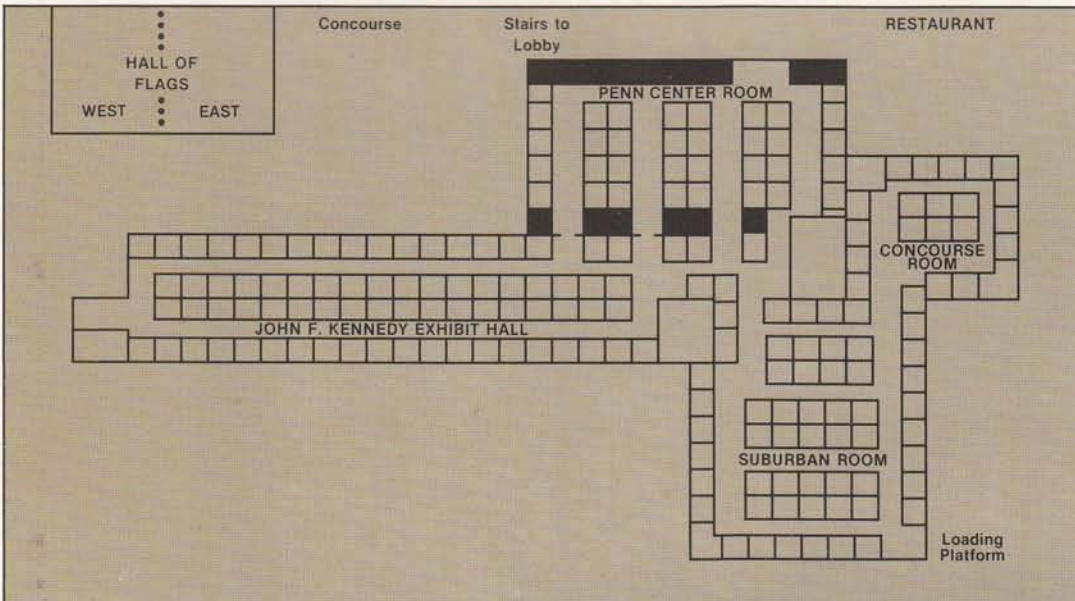

Meeting Room Specifications

Second and Third Floors

Room	Size	Square Feet	Ceiling Height	Meeting Theatre	Meeting Schoolroom	Banquet Rounds of 10
GRAND BALLROOM	81' x 119'	9639	23' 9"	2400	650	1500**
West Ballroom	81' x 54'	4374*	23' 9"	600	250	500
East Ballroom	81' x 36'	2916*	23' 9"	350	120	280
Assembly Area	81' x 29'	2349*	10'	250	120	180
Tiered Balcony	34' x 61'	1974	From 8'	350	150	220
North & South Balcony	—	—	To 9' 6"	—	—	214
CAFE CAREME	—	1100	11'	140	—	100
PENNSYLVANIA ROOM	49' x 91'	4499	10'	600	300	520
Pennsylvania-East	49' x 37'	1813	10'	220	120	200
Pennsylvania-West	49' x 54'	2646	10'	400	200	320
CONSTITUTION/ INDEPENDENCE RMS.	31' x 68'	2108	9' 3"	250	125	210
Constitution Room	31' x 37'	1047	9' 3"	150	70	120
Independence Room	31' x 25'	650	9' 3"	100	45	70
'76 ROOM	17' x 37'	629	7' 10"	75	30	60
DELAWARE VALLEY SUITE	17' x 60'	1156	8' 4"	140	60	120
Parlor A	17' x 17'	289	8' 4"	30	16	30
Parlor B	17' x 17'	289	8' 4"	30	16	30
Parlor C	17' x 17'	289	8' 4"	30	16	30
Parlor D	17' x 17'	289	8' 4"	30	16	30
FRANKLIN ROOM	19' x 16'	—	8' 7"	30	16	30

*EXCLUDED FROM TOTAL TO AVOID DOUBLE COUNTING

**PLUS 30 ADDITIONAL FOR HEAD TABLE ON STAGE

Fifth Floor

Room	Size	Square Feet	Ceiling Height	Meeting Theatre	Meeting Conference	Banquet Rounds of 10
527	25' x 11'	268	8' 3"	35	20	30
530	23' 10" x 12'	312	8' 3"	35	20	30
534	25' 7" x 12'	300	8' 3"	35	20	30
540	24' 1" x 11' 10"	388	8' 3"	35	25	30
546	25' 1" x 12'	312	8' 3"	35	25	30
548	23' 5" x 12'	276	8' 3"	35	25	30
554	25' 5" x 12'	388	8' 3"	35	25	30
556	16' 9" x 13' 2"	214	8' 3"	25	15	20
558	19' x 13' 2"	247	8' 3"	25	15	20
545	25' 2" x 10' 8"	275	8' 3"	25	15	20
547	22' 8" x 10' 9"	286	8' 3"	25	15	20
553	23' 6" x 10' 8"	231	8' 3"	25	15	20

Concourse

Room	Size	Square Feet	Ceiling Height	Meeting Theatre	Meeting Conference	Banquet Rounds of 10
					Schoolroom	
HALL OF FLAGS	74' x 50'	3700	9' 8"	350	110	320
East Section	37' x 50'	1850	9' 8"	175	50	140
West Section	37' x 50'	1850	9' 8"	175	50	140
EXHIBIT HALL	—	30,000	9' 6" - APPROX.	200	Booths 8' x 10' and 7' x 10'	
Penn Center Room	65' x 112'	(7496)	7' 9"	700	250	600
Concourse Room	52' x 65'	(3380)	7' 9" x 9' 6"	200	70	150
Suburban Room	81' x 94'	(7614)	8' 9" x 9' 6"	—	—	—
JFK Room	49' x 212'	(10,938)	8' 9" x 9' 6"	—	—	—

The PHILADELPHIA CENTRE HOTEL

A Tollman-Hundley Hotel



The Philadelphia Centre Hotel is convenient to the Schuylkill Expressway, the New Jersey and Pennsylvania Turnpikes and the AMTRAK station. Parking is available directly across from the hotel.

For more information about your meeting, please write our Director of Sales or call collect.

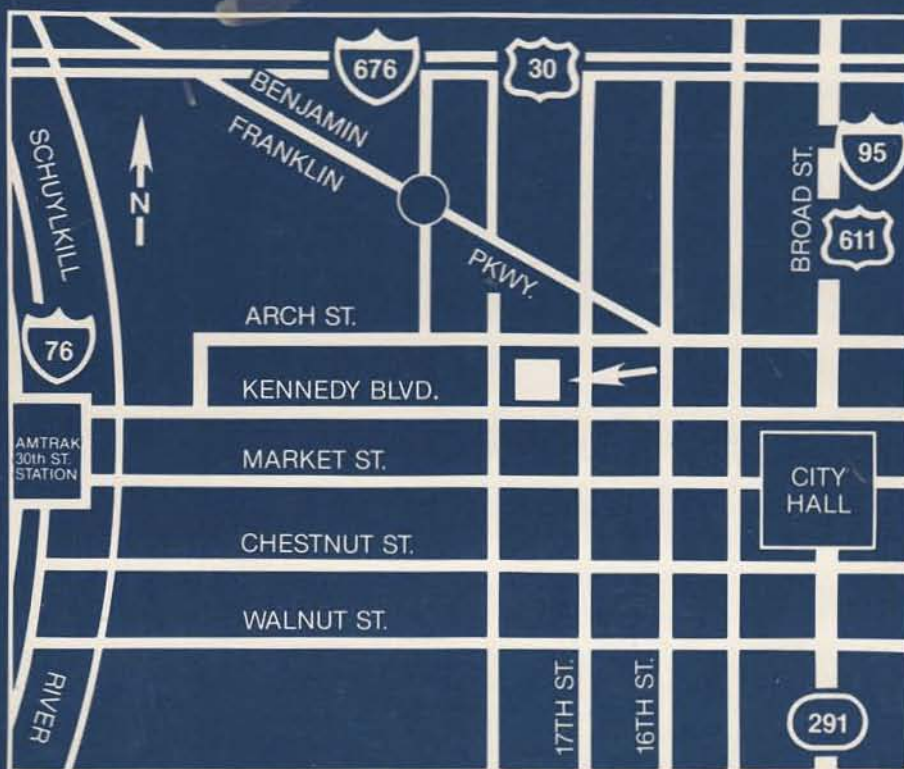

1725 John F. Kennedy Boulevard, Philadelphia, Pennsylvania 19103
For information or reservations, call 215-568-3300 or 800-523-4033.
In PA, call 800-462-4948.

The
PHILADELPHIA
CENTRE HOTEL A Tollman-Hundley Hotel

1725 J. F. Kennedy Boulevard
Philadelphia, Pennsylvania 19103
215-568-3300

GREATER PHILADELPHIA REGIONAL CONFERENCE
N.A. #4

APRIL 4th - 6th, 1986

Please reserve room(s) for person(s):

NAME

SHARING WITH

ADDRESS

FIRM

CITY STATE ZIP

Will arrive on at m
(day) (date) (time)

Will depart on at m
(day) (date) (time)

To insure Reservations, Room Requests Must Be Received 21 days
Prior to Scheduled Arrival.

If arrival is after 6 pm, we require a one-night deposit or payment of
the room guaranteed through American Express credit card to
hold your room.

CHECK OUT TIME — 12 NOON

The Philadelphia Centre Hotel

1725 JOHN F. KENNEDY BOULEVARD, PHILADELPHIA, PENNSYLVANIA 19103
215/568-3300

CONVENIENT PARKING FOR GUESTS

Convenient to all modes of transportation, regularly scheduled airport
limousine service. In the heart of cultural and historical Philadelphia.
Near the Philadelphia Civic Center. Nearby shopping. Variety of guest
rooms and suites. Total hotel service. Color T.V. Soft drink vending
machines and complimentary ice on each floor. Completely air condi-
tioned. Variety of Restaurants include: Crossroads — cafe atmosphere
with full menu, Pancho 'n Richies — intimate dining and cocktails,
Amelia's — our lobby lounge, and, a 24 hour take-out deli.

CHECK ACCOMMODATIONS PREFERRED

Single	\$40.00
Double	\$40.00
Triple	\$45.00
Quad	\$50.00

If room is not available at rate requested, reservation will be made at nearest
available rate.

Authorize guaranteed payment through
American Express Credit Card No.

**Place
Stamp
Here**

**The Philadelphia Centre Hotel
1725 John F. Kennedy Boulevard
Philadelphia, Pa. 19103**

Attn. Reservation Office