

*5th Greater Philadelphia  
Regional Convention*



*Step Up To Recovery*  
*March 27, 28, 29, 1987*

## THE TWELVE STEPS

1. We admitted that we were powerless over our addiction, that our lives had become unmanageable.
2. We came to believe that a power greater than ourselves could restore us to sanity.
3. We made a decision to turn our will and our lives over to the care to God as we understood Him.
4. We made a searching and fearless moral inventory of ourselves.
5. We admitted to God, to ourselves, and to another human being the exact nature of our wrongs.
6. We were entirely ready to have God remove all these defects of character.
7. We humbly asked Him to remove our shortcomings.
8. We made a list of all persons we had harmed, and became willing to make amends to them all.
9. We made direct amends to such people wherever possible, except when to do so would injure them or others.
10. We continued to take personal inventory, and when we were wrong promptly admitted it.
11. We sought through prayer and meditation to improve our conscious contact with God, as we understood Him, praying only for knowledge of His will for us, and the power to carry that out.
12. Having had a spiritual awakening as a result of those steps, we tried to carry this message to addicts and to practice these principles in all our affairs.

Welcome



G.P.R.C.-N.A.

## WELCOME

to the 5th Greater Philadelphia Regional  
Convention of Narcotics Anonymous.

The GPRCNA Hospitality Suite is located in  
Room 160-161. Registration Desk will be  
outside the Delaware Ballroom. The  
GPRCNA Store will be located in Room 159.  
Name tags must be worn for admittance to  
all functions.

We would ask everyone to be responsible  
to uphold the good reputation of N.A. for  
future conventions.

In the spirit of love and service —  
5th GPRCNA

Friday, March 27, 1987

**REGISTRATION — Outside Delaware Ballroom**

**MARATHON MEETING BEGINS — Fairmount Room**

### OPEN MEETING

**7 P.M.**

Speakers Meeting

Delaware Room

10:30 P.M.-12:00 A.M.

Beach Ball Podium  
Step Up To Recovery  
(Delaware 2 & 4)

10:30 P.M.-12:00 A.M.

Just For Today  
(Delaware 1)

10:30 A.M.-12:00 P.M.

What else is there?  
(Delaware 3)

10:30 P.M.-2:00 A.M.

Dance Commonwealth

## SATURDAY MARCH 28, 1987

TIME	FUNCTION	LOCATION
9:00 A.M.-5:00 P.M.	REGISTRATION	DELAWARE BALLROOM
9:00 A.M.-10:30 A.M.	GAYS	DELAWARE 2 & 4
9:00 A.M.-10:30 A.M.	STEP WORKSHOP	DELAWARE 1
9:00 A.M.-10:30 A.M.	H & I WORKSHOP	DELAWARE 3
11:00 A.M.-12:30 P.M.	N.A. HISTORY IN PHILA.	DELAWARE 2 & 4
11:00 A.M.-12:30 P.M.	RECOVERY & RELAPSE	DELAWARE 1
11:00 A.M.-12:30 P.M.	YOUTH & RECOVERY STACI	DELAWARE 3

TIME	FUNCTION	LOCATION
1:30 P.M.-3:00 P.M.	WOMEN'S MEETING	DELAWARE 2 & 4
1:30 P.M.-3:00 P.M.	TRADITIONS WORKSHOP	DELAWARE 1
1:30 P.M.-3:00 P.M.	P.I. WORKSHOP	DELAWARE 3
3:15 P.M.-4:45 P.M.	MEN'S MEETING	DELAWARE 2 & 4
3:15 P.M.-4:45 P.M.	EXPERIENCE, STRENGTH & HOPE THROUGH N.A.	DELAWARE 1
3:15 P.M.-4:45 P.M.	SPONSORSHIP HENRY	DELAWARE 3

# **BANQUET**

**BRANDYWINE BALLROOM**

**OPENING PRAYER**

**DINNER**

**READERS**

**CHAIR**

**ANNIVERSARIES**

**AREA RECOGNITION**

**CLEANTIME COUNTDOWN**

**SPEAKER**

**DANCE — BRANDYWINE BALLROOM**

**10:30 P.M. — 3:00 A.M.**

**SUNDAY, MARCH 29, 1987**

**BREAKFAST**

**9:00 A.M. — 10:00 A.M.**

**SPIRITUAL MEETING**

**10:30 A.M. — 12:30 P.M.**

**Commonwealth H & J**

**SPEAKERS**

**CLOSING**

## And A Special Thanks



TO THE HOTEL STAFF, CONVENTION COMMITTEE,  
AND ESPECIALLY OUR HIGHER POWER.

### JUST FOR TODAY

*Tell yourself —*

**JUST FOR TODAY** my thoughts will be on my recovery, living and enjoying life without the use of drugs.

**JUST FOR TODAY** I will have faith in someone in N.A. WHO BELIEVES IN ME AND WANTS TO HELP ME IN MY RECOVERY.

**JUST FOR TODAY** I will have a program. I will try to follow it to the best of my ability.

**JUST FOR TODAY** through N.A. I will try to get a better perspective on my life.

**JUST FOR TODAY** I will be unafraid, my thoughts will be on my new associations, people who are not using and who have found a new way of life. So long as I follow that way, I have nothing to fear.

### THE TWELVE TRADITIONS

1. Our common welfare should come first; personal recovery depends on N.A. unity.
2. For our Group purpose there is but one ultimate authority—a loving God as He may express Himself in our Group conscience; our leaders are but trusted servants, they do not govern.
3. The only requirement for membership is a desire to stop using.
4. Each Group should be autonomous, except in matters affecting other Groups, or N.A., as a whole.
5. Each Group has but one primary purpose—to carry the message to the addict who still suffers.
6. An N.A. Group ought never endorse, finance, or lend the N.A. name to any related facility or outside enterprise, lest problems of money, property or prestige divert us from our primary purpose.
7. Every N.A. Group ought to be fully self-supporting, declining outside contributions.
8. Narcotics Anonymous should remain forever non-professional, but our Service Centers may employ special workers.
9. N.A., as such, ought never be organized; but we may create service boards or committees directly responsible to those they serve.
10. N.A. has no opinion on outside issues; hence the N.A. name ought never be drawn into public controversy.
11. Our public relations policy is based on attraction rather than promotion; we need always maintain personal anonymity at the level of press, radio, and films.
12. Anonymity is the spiritual foundation of all our Traditions, ever reminding us to place principles before personalities.

## The Serenity Prayer

**G**od grant me the  
Serenity to accept the things  
I cannot change;

**C**ourage to change the things I  
can; and  
Wisdom to know the difference.

**L**iving one day at a time;  
enjoying one moment at a time;  
Accepting hardship  
as the pathway to peace;

**T**aking, as He did, this sinful  
world as it is, not as I would  
have it;

**T**rusting that He will make all  
things right if I surrender  
to His will;

**T**hat I may be reasonably happy  
in this life, and supremely  
happy with Him forever in  
the next. Amen.

*Reinhold Niebuhr*



**FREEDOM**

STEP UP TO RECOVERY 5<sup>TH</sup> GPRC-NA

MARCH



27-29



1987



County





*Step Up To  
Recovery*

5th G.P.R.C.-NA

Danny M.

Nº 459

**G. P. R. C. N. A.**

**BANQUET**

**SATURDAY, MARCH 28, 1987**

Nº 221

**G. P. R. C. N. A.**

**SPIRITUAL**

**BREAKFAST**

**SUNDAY, MARCH 29, 1987**

*Step Up To Recovery*



**5th G.P.R.C.-NA**

A  
B  
C  
D  
E  
F  
G  
H  
I  
J  
K  
L  
M  
N  
O  
P  
Q  
R  
S  
T  
U  
V  
W  
X  
Y  
Z

A

B

C

D

E

F

G

H

I

J

K

L

M

N

O

P

Q

R

S

T

U

V

W

X

Y

Z

In Loving



Service

Greater Philadelphia Regional Services Committee

P.O. Box 42628

Philadelphia, PA 19101-2628

TO: The Fellowship of the Greater Philadelphia Region  
FROM: GPRC-NA 5 Convention Committee  
Treasure, J.R. F.

---

This is a financial account of the convention held  
this year at the Dunfey Hotel, March, 27, 28, 29, 1987

CREDITS

\$ 2561.50	Opening balance
14774.76	Fellowship dance gross receipts
29241.41	Total registration monies
2700.00	Gross merchandise receipts
1252.00	Donation from GPRSC.
2253.42	Interest earned
80.00	Outstanding checks
\$50863.09	Total Credits

---

DEBITS

\$ 3200.00	Fellowship dance expenses
907.20	Purchase of N.A. basic text
138.75	Bank service charges
50.80	Convention information expenses
325.00	Convention meeting expenses
1312.00	Merchandise cost
100.00	Printing
586.00	Program committee
228014.00	Hotel bill
215.00	Art work / banner
250.00	Balloons committee
456.75	Lit. for meetings at convention
21.00	Service charge for returned checks
848.66	Copying
460.00	Returned checks
1697.00	Registration pkg. materials
80.00	Outstanding checks
20.00	Banks night deposit bags
38628.53	TOTAL DEBITS

~~500~~

500 copies

In Loving



Service

Greater Philadelphia Regional Services Committee

P.O. Box 42628

Philadelphia, PA 19101-2628

Next meeting  
5-14-87 8:30PM

February 18, 1987

To The NA Fellowship:

25, 26, 27

The Greater Philadelphia Region of NA is planning a convention on March 27, 28 and 29, 1987 for the purpose of sharing our recovery from the disease of addiction. We are asking any interested members within the fellowship to consider attending this event to be held at the ~~Dunfey City Line Hotel~~, City Line Avenue and Monument Road, Philadelphia, PA. Our theme this year is "~~Step Up to Recovery~~". *Adams Mark - City Line + Monument. Spiritual Connection*

Advanced registration for ~~\$12~~<sup>10</sup> is open until March ~~15~~<sup>10</sup>, and ~~\$15~~ at the door. In addition to the around the clock meetings and workshops we have scheduled a Saturday night banquet. The cost of the banquet is ~~\$25~~<sup>20</sup>, we will also have a Sunday morning brunch at the cost of \$10. There will be dances on both Friday and Saturday nights. *No one may attend the banquet and/or brunch without being registered.*

Arrangements for sleeping rooms may be made directly with the Hotel at the cost of ~~\$60~~/single and ~~\$70~~/double per night by phoning ~~215-667-0200~~. *65 75 80-triple+quad*

1-800-231-5858

If you plan to attend we encourage you to register with the enclosed flyer as soon as possible. Payment can be made to GPRC-NA, PO Box 42628, Phila., PA 19101-2628. ~~For more information call Alice/Margie 215-534-2887 or Steve/Sharon 215-925-7766.~~ We look forward to hearing from you soon.

*Dennis D. 423-1761 - Dennis M. 879-1172*

Yours In Fellowship,

*Convention*

The Public Information  
Committee of the Greater Philadelphia  
Regional Convention - NA

*Therapie Owens*

*H: 534-8782*

*(After 10:30 p.m.)*

*W: 787-9132*

*(After 11 a.m.)*

February 19, 1987

To Whom It May Concern:

25 26 27

The Greater Philadelphia Region of Narcotics Anonymous is planning a convention on March ~~27~~, ~~28~~ and ~~29~~, 1987 -- for the purpose of sharing our recovery from the disease of addiction. In the past years, the convention committee has given away free registration to people receiving treatment in hospitals and institutions. We are pleased to announce that this year we will continue this tradition. The Fellowship has made available a limited number of free registrations. We would like your institution to consider accepting some of these registrations.

*Adams Mark Hotel,*

The convention is being held at the ~~Dunfee~~ City Line Hotel, City Line Avenue and Monument Road, Philadelphia, PA. The registration includes meetings and workshops around the clock and dances Friday and Saturday nights. Our theme this year is "~~Stop Up To Recovery~~". Through our own experiences we have found this event to be very helpful in our recovery.

*"Spiritual Connection"*

If your institution is interested, we ask that you notify us as soon as possible by contacting ~~Rob Upleger 215-857-1190~~. We look forward to hearing from you soon.

In Loving Service,

*Dennis D., 215-~~422-1234~~  
537-1302*

*CONVENTION*  
The ~~Fellowship~~ Information Committee  
of The Greater Philadelphia Regional  
Convention *of* Narcotics Anonymous  
*FOR*

Attachment

P.S. The free registrations are only available to those receiving treatment not to the staff.

In Loving



Service

Greater Philadelphia Regional Services Committee

P.O. Box 42628  
Philadelphia, PA 19101-2628

PAGE #2- Financial Report

50863.09	TOTAL CREDITS
38682.53	TOTAL DEBITS
12180.56	ENDING BALANCE
7000.00	Donation to GBRSC. -N.A.
5180.56	Carried to 1988 convention account

---

WE OF THE CONVENTION COMMITTEE ARE GRATEFUL

FOR THE CHANCE TO SERVE IN THIS MANNER.

THANK GOD FOR N.A.

Submitted this 16th day of MAY, 1987

J.R. F. Treasurer

# PHILADELPHIA ELECTRIC COMPANY

2301 MARKET STREET  
P.O. BOX 8699  
PHILADELPHIA, PA. 19101

CLIFFORD BRENNER  
VICE-PRESIDENT  
CORPORATE COMMUNICATIONS DEPARTMENT

(215) 841-4100

February 13, 1987

Rob Upleger  
Greater Philadelphia Regional  
Services Committee  
P.O. Box 42628  
Philadelphia, PA 19101-2628

Dear Mr. Upleger:

Thank you very much for your letter of February 10, requesting the use of our Crown Lights in conjunction with the 5th Annual Narcotics Anonymous Convention.

Please be assured that your request will be given every consideration, consistent with both appropriateness and the availability of the Crown Lights for the time period you have indicated.

With respect to the latter, it should be noted that requests for the use of the Crown Lights have begun to exceed substantially their availability. Under these circumstances, it will not be possible to accommodate every request.

Sincerely,

A handwritten signature in blue ink, appearing to read "Cliff Brenner". The signature is stylized and fluid, with a long horizontal stroke at the end.



# 5<sup>TH</sup> Greater Philadelphia Regional Convention

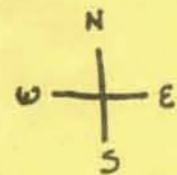

U.S. 76 EAST

\* City Line exit

U.S. 76 WEST

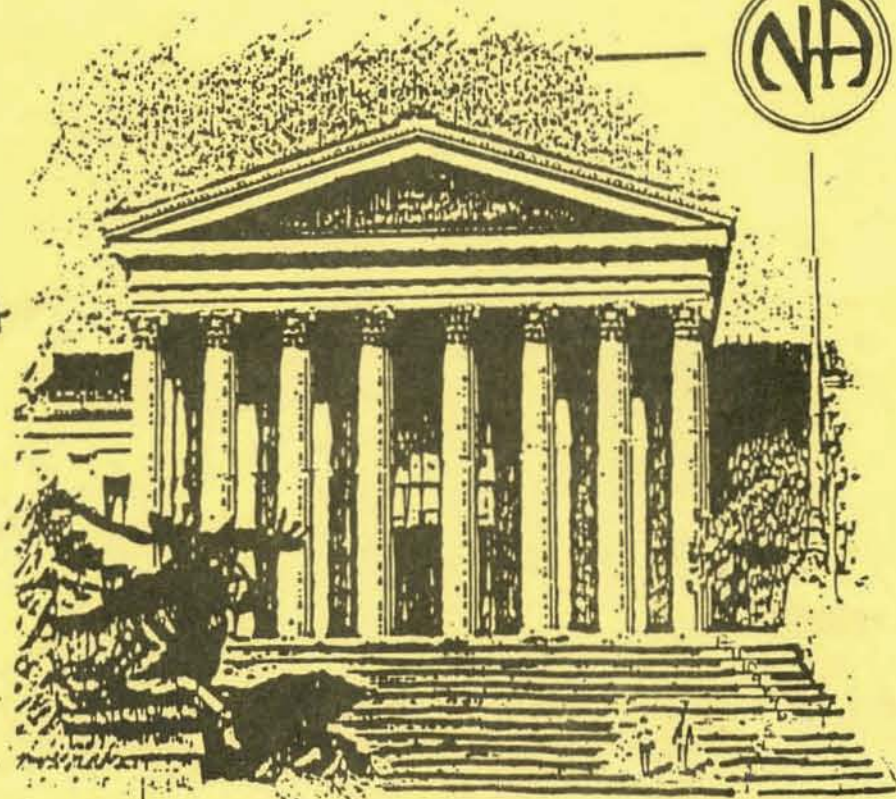

## Step Up To Recovery

March 27, 28, 29<sup>TH</sup> 1987

Dunfey City Line Hotel

City Line ave. & Monument rd.

Hotel Rates:

single 60<sup>00</sup>/double 70<sup>00</sup>

Reservations by 3-8-87 Tel: 215-667-0200

Payable To: G.P.R.C. - NA P.O. Box 42628 Phila. Pa. 19101  
-2628

Registration: # 12<sup>00</sup>

NAME:

BANQUET: # 25<sup>00</sup>

Address:

SUNDAY BRUNCH # 10<sup>00</sup>

Call: Alice & Marge - 215-534-2887

Total Package in Advance # 45<sup>00</sup> (#50<sup>00</sup> at the Door) Cut off date: 3-15

FOR MORE INFORMATION: Call - Steve & Sharon 215-925-7766



**GPCC-NA IS HAVING ANOTHER**

**LATE NITE ROLLER SKATING**

**DISCO PARTY!**

• **GET PHYSICAL IN  
SUPPORT OF THE  
CONVENTION!**



• **ADMISSION: \$3.00**

• **SKATES: \$1.00**

• **STARTING PROMPTLY**

**AT 11:30 pm. TILL 2:00 am.**

**~ FUN... EXERCISE... FELLOWSHIP ~**

**SATURDAY ~ MARCH 16<sup>TH</sup>**

**» KENSINGTON ROLLER «  
RINK**

**» kensington & ontario streets «  
n.e. phila.**

**GPRC NA**

**SPONSORS**

**SAT.**

**A FUNDRAISING**

**MAY 23<sup>rd</sup>**

**DANCE**

**9:30 pm**

**til**

**2 AM**



**FIRST UNITARIAN CHURCH**

**22nd & CHESTNUT**

**FELLOWSHIP**

**FUN**

**admission**

**\$5.00**



**9:30 PM**

**IS THE TIME!**

**JUNE 13-20-27**

**IS THE DATE!**

**FIRST UNITARIAN CHURCH  
22<sup>nd</sup> & CHESTNUT STS.**

**IS THE PLACE!**

**A FUNDRAISING DANCE**

**IS THE REASON!**

**\* SPONSORED BY THE GPRC-NA**

**» TILL 2am. «**

**GUARANTEED  
FUN & EXCITEMENT!**

**ADMISSION - \$5.00**

**BE THERE!**

Welcome to the

# Dunfey

CITY LINE HOTEL

City Line Avenue and Monument Road, Philadelphia, Pennsylvania 19131 (215) 667-0200

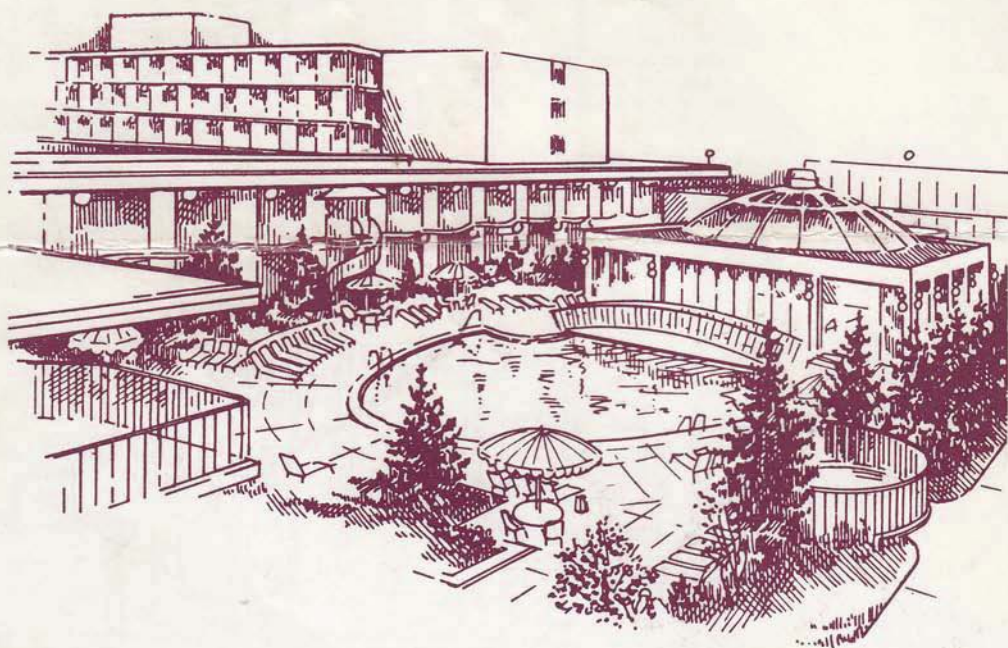

## Guest Directional Map

WE LOOK FORWARD TO SERVING YOU!

**KEY:**

**ENTRANCES/EXITS:**

☒ First Floor

☒ Second Floor

**ELEVATORS:**

■ STAIRWAYS

**LAUNDROMATS:**

☐ Laundromats are located in B & J wings, 3rd floor.

▨ Grey areas indicate buildings or sections with NO first floor or access from first floor.

*"OUR ROOM"*

*WEIGHT ROOM*

*"OUR" POOL*

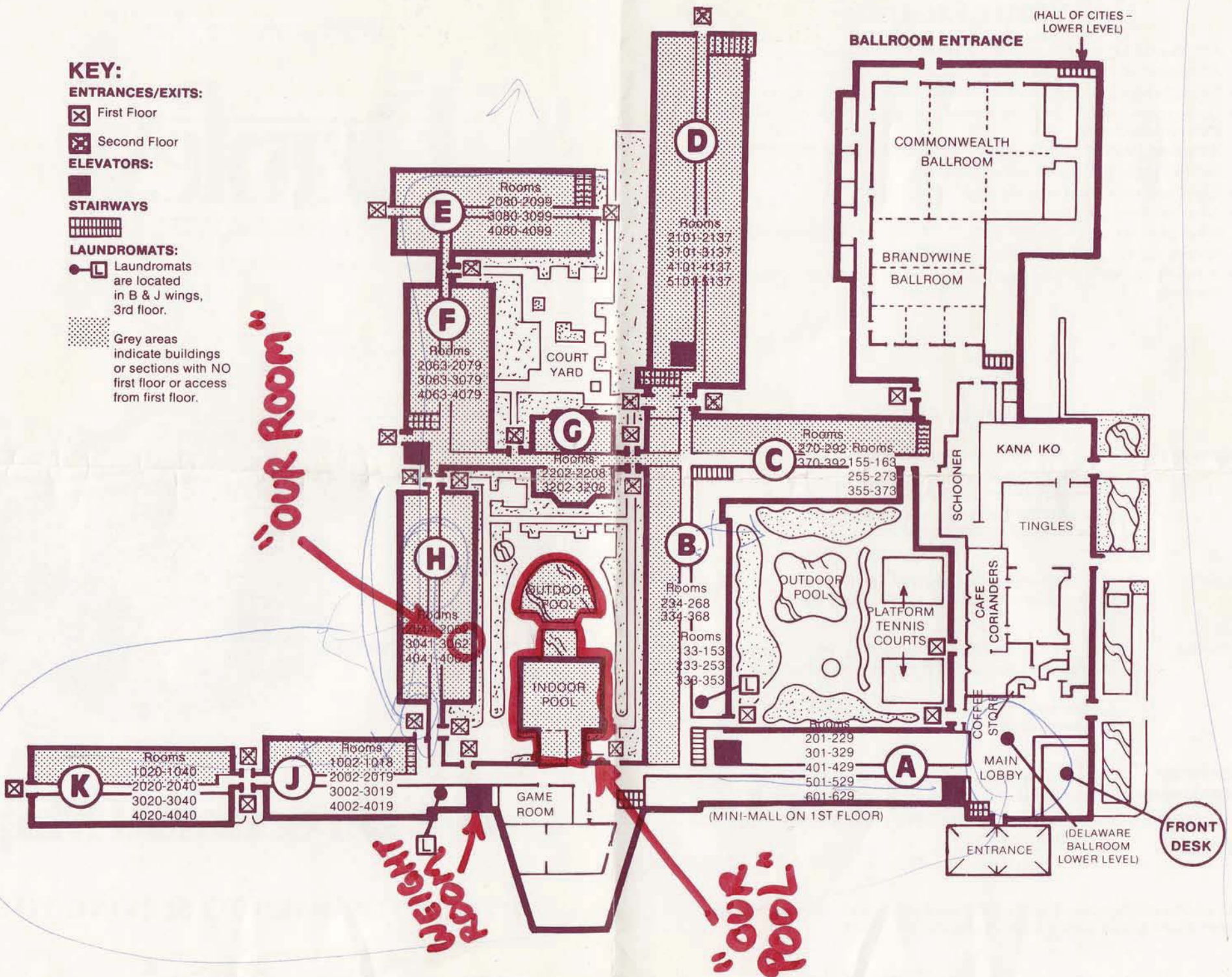

## HOTEL FACILITIES

- A mini-mall for your shopping convenience featuring complete gift shops.
- An indoor/outdoor as well as two outdoor swimming pools.
- Hydrotherapy whirlpool and table tennis available at indoor pool complex.
- Game room across from indoor pool with snack machines, and the latest in electronic wizardry.
- A marked jogging course behind "D" Building in our parking lot.
- Two regulation platform tennis courts.
- Children's recreation area (behind "K" Building).
- A barber shop for your convenience.
- A full service travel agency, "Executive Travel", in our mini-mall.
- Eastern Airlines desk in the main lobby.
- A Ticket Jar (Main Lobby) featuring tickets to most major cultural events in the area.

## DINING GUIDE

### BREAKFAST

Our *Café Coriander's*, just off the main lobby, serves complete breakfast offerings, seven days a week.

In a hurry? *The Coffee Store* offers fine, fast fare for your busy morning. The Coffee Store is open 24 hours daily, seven days a week for your convenience.

### LUNCH

*Café Coriander's* offers fabulous lunch selections in a delightfully comfortable atmosphere, seven days a week.

### DINNER

Our unique and exotic *Kana Iko*, Philly's only authentic Polynesian restaurant, will excite your senses and satisfy your appetites!

*Coriander's* offers dinner specialities for your dining convenience in a cafe atmosphere.

### LOUNGES/ ENTERTAINMENT

*Tingles Lounge*, the Main Line's sizzling hotspot, will tempt you tremendously with their Happy Hour offerings!

*The Schooner*, adjacent to *Kana Iko*, offers an extensive menu of Polynesian drinks.

For additional information please consult our *Guest Services Directory*, located in your room. Thank you for staying at the *Dunfee City Line Hotel*.



PLEASE  
PLACE  
STAMP  
HERE

# Dunfey

CITY LINE HOTEL

City Avenue & Monument Road  
Philadelphia, PA 19131

Attn: RESERVATION DEPT.

**PLEASE DON'T FORGET —**

Make check or money order payable to

**DUNFEY CITY LINE HOTEL**

PLEASE DO NOT SEND CURRENCY

NARCOTICS ANONYMOUS

March 27-29, 1987

Name \_\_\_\_\_ Company \_\_\_\_\_

Address \_\_\_\_\_

City/State/Zip \_\_\_\_\_

Will Arrive On \_\_\_\_\_ Time \_\_\_\_\_ Will Depart On \_\_\_\_\_

Sharing Room With \_\_\_\_\_

Please indicate if room will be shared by a third adult; if so,  
an additional charge will prevail

Signature \_\_\_\_\_

Please do  do not  send confirmation

If the reservation is not honored on the day of arrival or is not cancelled before 4:00 p.m. on that day, the room will be billed for one night and then the reservation will be cancelled.

FOR DEPOSIT, SEND AMOUNT EQUAL TO FIRST NIGHTS ACCOMMODATION IN THIS ENVELOPE TO  
CONFIRM YOUR RESERVATION . . . AMERICAN EXPRESS, DINERS CLUB CARD, MASTERCARD, OR  
VISA WILL ALSO GUARANTEE YOUR RESERVATION

CARD NO. \_\_\_\_\_ EXP. DATE \_\_\_\_\_

Please circle preferred rate (if rate is not available nearest available rate will be assigned)	
Accommodations	Rate
SINGLE 1 person, 1 bed <input type="checkbox"/>	\$60.00
DOUBLE 2 people, 1 bed <input type="checkbox"/>	\$70.00
TWIN 2 people, 2 dbl. beds <input type="checkbox"/>	\$70.00
PARLOR <input type="checkbox"/>	Rates available on request
SUITE <input type="checkbox"/>	Contact hotel directly

Check-out time is 1 p.m. Guest rooms will be available after 4:00 p.m.

Reservations must be made before 3/6/87

**DunfeY**  
CITY LINE HOTEL

HOTEL SERVICES: 705 Deluxe Guest Rooms and Executive Suites/Color TV/Complimentary HBO, ESPN, CNN/Individual Climate Control/Free Parking Facilities/Indoor & Outdoor Pools/Meeting and Banquet Facilities for Groups of 10 to 1500/Located off I-76, 15 minutes from Historic Philadelphia and King of Prussia/Valley Forge Areas/Specialty Restaurants include King's Wharf and Kona Kai/Family Dining in Corianders/The Convenience of a 24 Hour Coffee Store/Relax in Overtures and Firehouse Tavern Lounges.