



de la vie
XXV
ANCE
RI
SEPTEMBER, 14-15-16-17, 1995

TOUR
WCNA
PARIS
FRANCE

de la vie
WCNA XXV
PARIS, FRANCE
SEPTEMBER 14, 15, 16, 17, 1995

WCNA XXV - PARIS, FRANCE - 14, 15, 16, 17, SEPT

THE WORLD'S UNION OF THE DEAF
WCNA XXV - PARIS FRANCE
14, 15, 16, 17, SEPT 1995

THE WORLD'S UNION OF THE DEAF
WCNA XXV - PARIS FRANCE
14, 15, 16, 17, SEPT 1995

THE WORLD'S UNION OF THE DEAF
WCNA XXV - PARIS FRANCE
14, 15, 16, 17, SEPT 1995

UNION DE LA VIE
WCNA XXV - PARIS FRANCE
14, 15, 16, 17, SEPT 1995

SAVING
RENT
MAY BE HANDLED
ONLY 130
OF SOME TYPE
RVS
APR 25 1995
MAIL ROOM
P.O. BOX 1000
PHILA DELPHIA PA
19103-1000
USA



World Convention Corporation

PO Box 9999, Van Nuys, CA 91409-9999

(818) 773-9999

August 28, 1995

Dear WCNA-25 Registrant:

The World Convention Corporation wishes to thank you for your support and we look forward to seeing you this September in Paris, France for WCNA 25, "UNE NOUVELLE VISION DE LA VIE." We recognize that this may be the first time many members may be attending a WCNA event, outside of your home country, region or area. In order to alleviate some of the potential confusion, which can be associated with a trip such as this, we have included some travel tips. Hopefully, they will enable you to enjoy a pleasurable trip and smooth arrival into Paris and finally to WCNA 25 at Disneyland.

Required Identification and Emergency Contacts:

- Make sure that your Passport is current and valid. You should make a copy of the first page and keep it in your luggage (just in case you lose your passport).
- If your passport is lost or stolen make and official report in any police station.

Following are the telephone numbers for some of the consulates in Paris:

United States -----	40.20.01.99
Italy -----	45.20.06.06
Great Britain-----	42.66.06.68
Portugal -----	44.06.88.90
Spain -----	47.66.06.68
Germany -----	42.99.78.00

- For medical emergencies call:
18 (from any telephone booth) or;
SOS-Medecins or;
47.07.77.77 or 43.37.77.77
- For telephone information: dial 12
- To call the police: dial 17

Airport Traveling to Paris

- You should arrive at your international carrier at least 90 minutes prior to your departure.
- Carry your passport on your person when traveling. You will need it for checking your luggage at departure.
- Wear comfortable fitting clothes and shoes on the flight. Especially wear comfortable shoes because swelling may occur due to the duration of the flight and the altitude.

Arriving at the Airport in Paris

- A Minibus may, depending upon the airport of your arrival, take you from the plane to the terminal.
- Your passport will be required for entry into Paris within the terminal. There are directional signs that will guide you to the entry visa points.
- After your passport is stamped with an entry visa directional signs will then point you to the direction of the baggage claim area.

(Please read the Security Section)

- After retrieving your luggage, directional signs will indicate where to catch the shuttle bus for Disneyland Paris. The shuttle bus costs 80FF and runs 30-45 minutes.

Security

- The city of Paris is very security conscious pertaining to terrorism. When in the airport, please take the following suggestions when in Paris airports:
- Keep your luggage with you at all times
- Don't leave your luggage unattended
- Don't accept packages to carry from people that you don't know
- Do not carry any items that may look like a weapon
- Keep your passport with you at all times

Currency Conversion

- **The currency used in France and at WCNA 25 will be the French Franc.** All merchandise sold at the convention will have to be paid for in French Francs. Make sure that you have changed your money before coming to France or upon arrival. There are exchange offices in most international airports and in most central neighborhoods in Paris. Money may also be exchanged at Disneyland Paris at the front desk in your hotel. Typically, you can get better exchange rates in Paris rather than in your home country.
- As always, be conscious of carrying large amounts of money on your person. Your safety is of paramount importance to the World Convention Corporation.

Due to excessive bank processing fees, no personal checks will be accepted at WCNA-25. There are cash (ATM) machines located at Disneyland Paris. We apologize for any inconvenience this may cause.

Time

- Europe utilizes military time to denote the time of day. This means that 11:30AM is stated as 11h30, but 11:30PM is stated as 23h30. 12:00 midnight would be 00h00, while 12 noon would be 12h00. Use the military standard for time dependent activities while in Paris.

Language

- While in Paris, it is a good idea to have a French phrase book and dictionary because many people will not be able to speak your language. For example, most taxi drivers and train employees speak only French.

WCNA XXV OFFICIAL DISCOUNT TRAVEL PACKAGES TO PARIS

Official discount travel packages are available from the following North American cities through our official travel agency, Travel Smart, Inc.

CITY	*PER PERSON	CITY	*PER PERSON
Montreal	\$1029	Chicago	\$949
Boston	899	Indianapolis	979
Hartford	899	Kansas City	999
New York	899	St. Louis	999
Philadelphia	899	Dallas	999
Wash./Baltimore	899	Houston	999
Pittsburgh	949	San Diego	999
Raleigh	949	Los Angeles	999
Charlotte	949	San Francisco	999
Atlanta	949	Albuquerque	1079
Orlando	949	Denver	1079
Miami	949	Las Vegas	1079
New Orleans	999	Seattle	1099
Nashville	999	Toronto	1199
Cincinnati	949	Calgary	1429
Cleveland	949	Edmonton	1429
Detroit	949	Vancouver	1429
Minneapolis	979		

*Based on midweek/weekend prices.
For round trip weekend travel, add \$20.00 US.

Packages include: round trip air transportation on US Air or Air France, 5 days/4 nights accommodations (based on double occupancy) at the headquarters, Hotel New York in Disneyland Paris; shuttle service between the Paris Airport and Disneyland Paris; and all taxes. All packages are priced per person and based on availability. Connecting flights from other cities are available for an additional charge.

All travel must occur between 8 September and 22 September in order to get the discount airfare. If you would like to stay longer than five days at the Hotel New York, add \$66US per day to the cost of the package. If you would like to stay additional days at another hotel in Paris, Travel Smart Inc. can assist you with your plans.

While there is no deadline on reservations, we suggest that you book your package early, preferably by 15 April 1995.



For more information and booking, call Travel Smart, Inc. at (800) 278-3113 in the US or (619) 278-3113 outside the US. Their normal business hours are Monday thru Friday, 8AM to 5PM Pacific Standard Time.

WCNA XXV

PARIS, FRANCE

SEPTEMBER 14, 15, 16, 17, 1995

WCNA XXV OFFICIAL DISCOUNT TRAVEL PACKAGES TO PARIS

Official discount travel packages are available from the following North American cities through our official travel agency, Travel Smart, Inc.

<u>CITY</u>	<u>*PER PERSON</u>	<u>CITY</u>	<u>*PER PERSON</u>
Montreal	\$1029	Chicago	\$949
Boston	899	Indianapolis	979
Hartford	899	Kansas City	999
New York	899	St. Louis	999
Philadelphia	899	Dallas	999
Wash./Baltimore	899	Houston	999
Pittsburgh	949	San Diego	999
Raleigh	949	Los Angeles	999
Charlotte	949	San Francisco	999
Atlanta	949	Albuquerque	1079
Orlando	949	Denver	1079
Miami	949	Las Vegas	1079
New Orleans	999	Seattle	1099
Nashville	999	Toronto	1199
Cincinnati	949	Calgary	1429
Cleveland	949	Edmonton	1429
Detroit	949	Vancouver	1429
Minneapolis	979		

*Based on midweek/weekend prices.
For round trip weekend travel, add \$20.00 US.

Packages include: round trip air transportation on US Air or Air France, 5 days/4 nights accommodations (based on double occupancy) at the headquarters, Hotel New York in Disneyland Paris; shuttle service between the Paris Airport and Disneyland Paris; and all taxes. All packages are priced per person and based on availability. Connecting flights from other cities are available for an additional charge.

All travel must occur between 8 September and 22 September in order to get the discount airfare. If you would like to stay longer than five days at the Hotel New York, add \$66US per day to the cost of the package. If you would like to stay additional days at another hotel in Paris, Travel Smart Inc. can assist you with your plans.

While there is no deadline on reservations, we suggest that you book your package early, preferably by 15 April 1995.



For more information and booking, call Travel Smart, Inc. at (800) 278-3113 in the US or (619) 278-3113 outside the US. Their normal business hours are Monday thru Friday, 8AM to 5PM Pacific Standard Time.

WCNA XXV

PARIS, FRANCE

SEPTEMBER 14, 15, 16, 17, 1995

Live From Paris!



**25th World Convention
16 September 1995
Paris, France**

Narcotics Anonymous will observe **WORLD UNITY DAY** on Saturday, 16 September 1995 at the 25th World Convention in Paris. A telephone link is available to allow you to hear the Unity Day Celebration and the entire Saturday night meeting.

We encourage you to plan events for this day which remind us that together, as a world-wide fellowship, we can ensure that no addict seeking recovery need die without a chance to find a better way of life.

The information and registration form you will need to link by telephone is on the opposite side of this flyer. The celebration will begin at 7:30pm European time (1:30pm Eastern, 12:30pm Central, 11:30am Mountain, 10:30am Pacific). We will then join together to say the Serenity Prayer at 8pm European Time.

Please join us and join the world!

Une nouvelle vision de la vie!

UNE NOUVELLE VISION DE LA VIE



WCNA XXV – PARIS FRANCE
14. 15. 16. 17. SEPT 1995



PARIS, L'ARC DE TRIOMPHE
PHOTOGRAPHIE DE PHILIP BERNARD

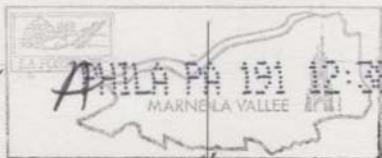

HAVING
GREAT

CESSY TIME 18-9-95



MERCHANDISE
SOLD OUT
EARLY. I DID
GET SOME STUFF

PITALE

DANNY MARINO
2225 BENSON ST.
PHILADELPHIA PA.
19152 USA

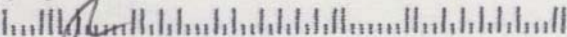

UNE NOUVELLE VISION

DE LA VIE



WCMA XXV

PARIS, FRANCE

14. 15. 16. 17. SEPT 1995

THE TWELVE STEPS OF NARCOTICS ANONYMOUS

1. We admitted that we were powerless over our addiction, that our lives had become unmanageable.
2. We came to believe that a Power greater than ourselves could restore us to sanity.
3. We made a decision to turn our will and our lives over to the care of God as we understood Him.
4. We made a searching and fearless moral inventory of ourselves.
5. We admitted to God, to ourselves, and to another human being the exact nature of our wrongs.
6. We were entirely ready to have God remove all these defects of character.
7. We humbly asked Him to remove our shortcomings.
8. We made a list of all persons we had harmed, and became willing to make amends to them all.
9. We made direct amends to such people wherever possible, except when to do so would injure them or others.
10. We continued to take personal inventory and when we were wrong promptly admitted it.
11. We sought through prayer and meditation to improve our conscious contact with God as we understood Him, praying only for knowledge of His will for us and the power to carry that out.
12. Having had a spiritual awakening as a result of these steps, we tried to carry this message to addicts, and to practice these principles in all our affairs.

Twelve Steps reprinted for adaptation by permission of AA World Services, Inc.

Bienvenue à WCNA-25 Paris



We welcome you to share a new vision of life. "As we recover, we gain a new outlook on being clean. We enjoy a feeling of release and freedom from the desire to use. We find that everyone we meet eventually has something to offer. We become able to receive as well as to give. Life can become a new adventure for us. We come to know happiness, joy, and freedom."¹

"Unity is the spirit that joins thousands of members around the world in a spiritual fellowship that has the power to change lives."²

Thank you for being a part of this new vision of life!

"Que la Fête Commence"

¹ reprinted from the *Narcotics Anonymous*, English Edition, page 88

² reprinted from *It Works: How & Why*, page 125

Note:

Bienvenue à WCNA-25 Paris

Nous vous invitons à parazer une nouvelle vision de la vie. «Au fur et à mesure que nous nous rétablissons, notre conception de l'abstinence s'élargit. Nous ressentons la joie d'être libérés du désir de consommer. Nous nous apercevons que tous les gens que nous rencontrons ont finalement quelque chose à nous offrir. Nous devenons capables de recevoir aussi bien que de donner. La vie peut devenir une nouvelle aventure pour nous. Nous en venons à connaître le bonheur, la joie et la liberté.»¹

«L'unité est le principe spirituel qui relie des milliers de dépendants de part le monde dans une fraternité qui a le pouvoir de changer nos vies.»²

Merci de faire partie de cette nouvelle vision de la vie!



Convidamos-te a partilhar uma nova visão de vida. «À medida que recuperamos ganhamos uma nova perspectiva sobre o viver limpo. Experimentamos uma sensação de alívio e de libertação do desejo de usar. Descobrimos que toda a gente que encontramos tem eventualmente algo para dar. Tornamo-nos capazes de receber, assim como de dar. A vida pode tornar-se uma nova aventura para nós. Passamos a conhecer a felicidade, a alegria e a liberdade.»¹

«É a unidade que faz com que se juntem milhares de membros em todo o mundo numa irmandade espiritual que tem o poder de mudar vidas.»²

Obrigado por fazerem parte desta nova visão da vida!

Te animamos a que compartas con nosotros una visión nueva de la vida. «A medida que nos recuperamos, adquirimos una nueva perspectiva sobre el hecho de estar limpios. Disfrutamos del alivio y de la liberación del deseo de consumir. Descubrimos que todas las personas que conocemos, a la larga tienen algo que ofrecemos. Nos convertimos en personas capaces tanto de dar como recibir. La vida puede convertirse en una aventura nueva. Llegamos a conocer el bienestar, la alegría y la libertad.»¹

«La unidad es el espíritu que conecta a miles de miembros de todo el mundo en una confraternidad espiritual que tiene el poder de cambiar vidas.»²

¡Gracias por formar parte de esta nueva visión de la vida.!



Wir heißen Dich willkommen, mit uns eine neue Vision vom Leben zu teilen. „Indem wir genesen, gewinnen wir eine neue Haltung zum Cleansein. Wir genießen ein Gefühl von Befreiung und Freiheit von dem Verlangen zu nehmen. Wir finden, daß alle, denen wir begegnen, letztendlich etwas anzubieten haben. Wir wurden fähig, sowohl anzunehmen als auch zu geben. Leben kann zu einem neuen Abenteuer für uns werden. Wir erfahren Glück, Freude und Freiheit.“¹

„Einigkeit ist der Geist, der Tausende von Mitgliedern rund um die Welt in einer spirituellen Gemeinschaft zusammenführt, welche die Macht hat, Leben zu verändern.“²

Danke, daß Du ein Teil dieser neuen Vision vom Leben bist!

“Que La Fête Commence”



General Information

For safety reasons, the New York Convention Centre will be a non-smoking facility throughout the convention. Smoking is allowed just inside the main entrance of the Convention Centre and in the Hotel New York. Please help us by only smoking in the designated smoking areas.

All times listed in this program are in European time which is based on a twenty-four hour clock. For example, 4:30 pm in the United States would be 16h30 in Paris.

The official currency of the convention is French francs. All cash sales will be accepted in French francs only. All prices include approximately 20% VAT (sales) tax and a small service charge for currency conversion.

The boat cruise will be on the *Vendettes du Pont Neuf* on the River Seine, in Paris, and is approximately a forty-minute ride from the Convention Centre by bus. Buses will depart from outside the main entrance of the Convention Centre immediately following the Friday night main meeting. The last bus will depart no later than 21h30. The bus ride to the cruise will include a sightseeing tour in Paris. The tour does not include sufficient time to actually stop at these sites.

The Saturday night Chateau Party at *Le Chateau Royal Du Vivier* in the French countryside town of Fontenay-Tresigny is approximately a twenty-minute ride from the Convention Centre by bus. Buses will leave for the chateau promptly at the time printed on your ticket. Return buses will run every thirty minutes beginning at 01h00, with the last bus leaving at 03h00.

All workshops and main meetings are open to addicts or anyone interested in finding out more about Narcotics Anonymous, however only addicts may share at these workshops. Marathon meetings are closed meetings, open only to addicts or those who think that they may be an addict.

In line with the belief that we can only keep what we have by giving it away, we offer the opportunity for members to give a newcomer donation to facilitate the attendance of newcomers with thirty days or less at the convention.

Responsibility Statement

Please keep in mind that your conduct is a reflection on NA. If you are unable to conduct yourself in a responsible manner, you will be asked to leave. Shirts and shoes must be worn in all hallways and public areas at all times. Please keep in mind not everyone stays up late nor all night. We need to have peace and quiet in the hallways between the hours of 21:00 and 8:00. Please keep the noise level in the rooms to a minimum. The committee has provided a hospitality suite for the convenience of group gatherings around the clock.

Clarity Statement

We are presented with a dilemma when NA members identify themselves as addicts and alcoholics or talk about "living clean and sober." The clarity of the NA message is blurred. To speak in this manner suggests that there are two diseases, that one drug is somehow separate from the rest requiring special recognition. Narcotics Anonymous makes no distinction between drugs. Our identification as ADDICTS is all inclusive allowing us to concentrate on our similarities, not our differences.

Press Statement

Our public relations policy is based on attraction rather than promotion; we need always maintain personal anonymity at the level of press, radio, and films. This is to protect the membership and the reputation of Narcotics Anonymous. We do not disclose last names, nor appear in the media as members of Narcotics Anonymous. No individual inside or outside the fellowship represents Narcotics Anonymous. If you are approached by members of the press, please contact Convention Information. They will be more than willing to assist you.



Registration

Registration is located in the main entrance hall of the New York Convention Centre.

Hours:

Wednesday	16h00 — 20h00
Thursday	10h00 — 13h00; 15h00 — 19h00; 21h00 — 23h00
Friday	10h00 — 13h00; 15h00 — 19h00; 21h00 — 23h00
Saturday	10h00 — 13h00; 15h00 — 19h00

We are not responsible for the replacement of lost registration badges. There will be no refunds on paid event tickets.

Convention Information

Convention Information is located in the lobby of the Convention Centre.

Hours:

Wednesday	18h00 — 24h00
Thursday	9h00 — 24h00
Friday	9h00 — 24h00
Saturday	9h00 — 23h00
Sunday	9h00 — 12h00

Our Committee is in need of people who speak both English and other languages. To volunteer for service contact the European Liaison Committee located in the lobby of the Convention Centre.

Merchandise and Jewelry Sales

The Merchandise Room is located at the New York Convention Centre in Salon AF.

Hours:

Thursday	10h00 — 13h00; 15h00 — 19h00; 21h00 — 23h00
Friday	10h00 — 13h00; 15h00 — 19h00; 21h00 — 23h00
Saturday	10h00 — 13h00; 15h00 — 19h00

The sale of merchandise by individuals in any of the convention facilities is strictly prohibited. Violators will be subject to immediate removal from all facilities.

The alternate store is tentatively scheduled for Sunday at 13h00 in the Merchandise Room. Anyone wishing to sell merchandise in the alternative store must have a written request, on letterhead from their region and/or area which authenticates that the merchandise is being sold in compliance with the Seventh Tradition. The request must be made no later than 18h00 Saturday to a World Convention Corporation Director in the Merchandise Room.

Disneyland Paris Map

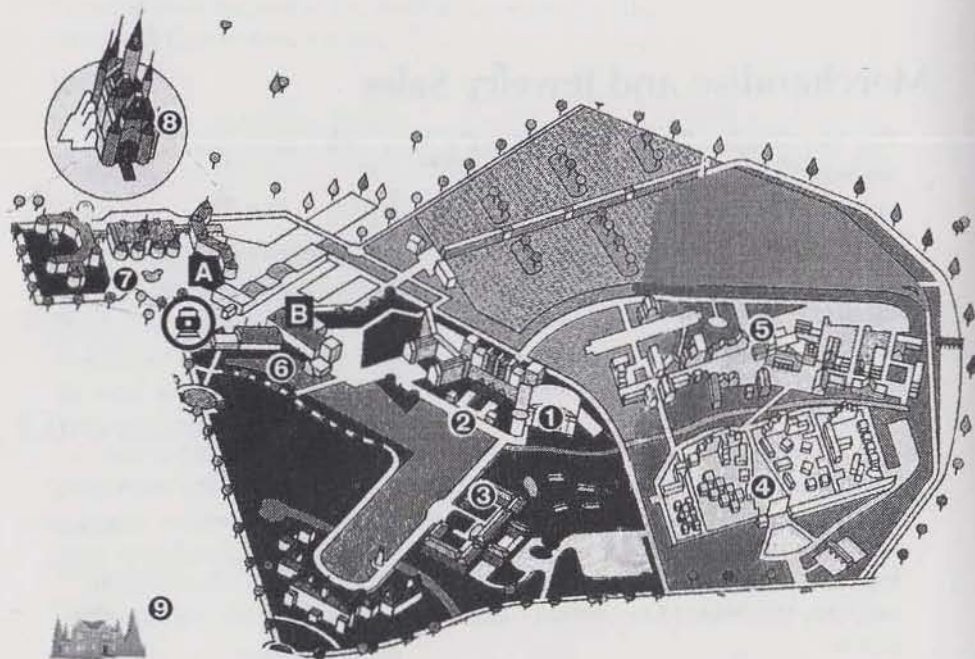

- ① New York Convention Centre
- ② Hotel New York
- ③ Sequoia Lodge
- ④ Santa Fe Hotel
- ⑤ Cheyenne Hotel
- ⑥ Festival Disney

- ⑦ Disneyland Hotel
- ⑧ Parc Disneyland
- ⑨ Davy Crockett
- A American Express Office
- B International ATM Machine
- ⓐ Train Station

Convention Centre Map

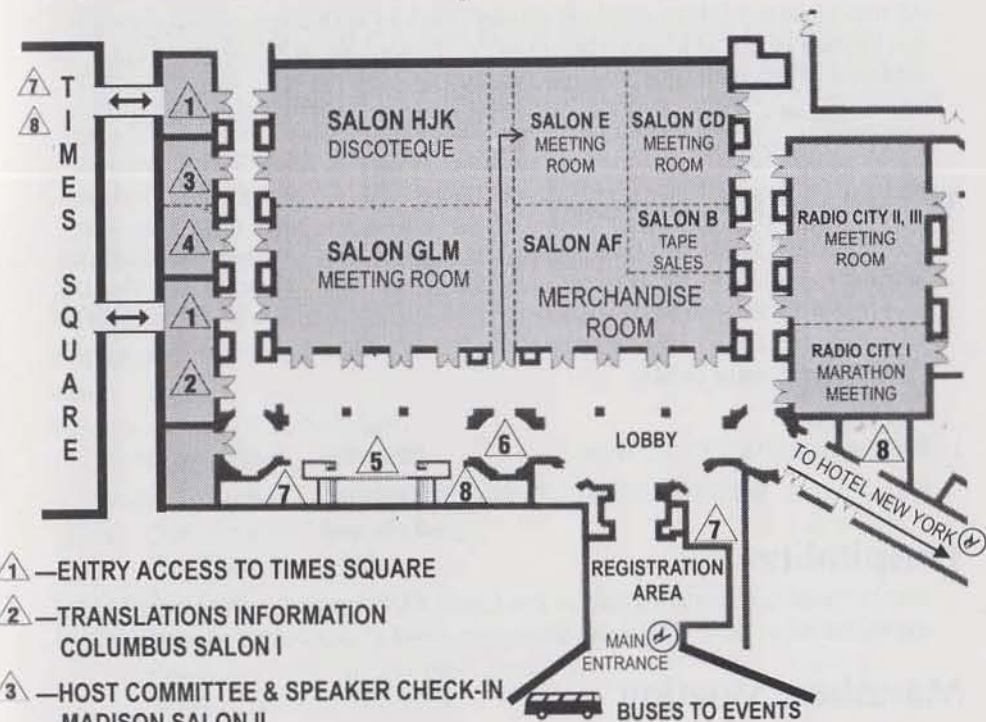

- ① — ENTRY ACCESS TO TIMES SQUARE
- ② — TRANSLATIONS INFORMATION COLUMBUS SALON I
- ③ — HOST COMMITTEE & SPEAKER CHECK-IN MADISON SALON II
- ④ — WORLD SERVICE OFFICE—EUROPE MADISON SALON I
- ⑤ — CONVENTION INFORMATION
- ⑥ — VOLUNTEER INFORMATION

- ⑦ — MEN'S RESTROOM
- ⑧ — WOMEN'S RESTROOM
- Ⓢ — DESIGNATED SMOKING AREAS



Speaker Check-in

All main and workshop speakers should check-in with the program committee located in the Madison Avenue Salon II upon arrival at the convention. In addition all speakers and chairpersons should report to their respective meeting rooms fifteen (15) minutes prior to the start of their scheduled meeting or workshop.

Volunteer Information

The European Liaison Committee will be coordinating and assigning all those wishing to volunteer for service during the convention. If you would like to sign up for service, or have already volunteered but need to be directed to your assigned area, please go directly to the ELC Desk located in the Convention Centre Lobby.

Hours:

Wednesday	18h00 — 21h00	Thursday	10h00 — 22h00
Friday	10h00 — 18h00	Saturday	10h00 — 14h00

Hospitality

The hospitality room is located in the Castle Club located on the sixth floor of the Hotel New York. Our committee is in need of volunteers all weekend.

Marathon Meeting

A Marathon Meeting will be held at the Convention Centre in Radio City I non-stop through the convention. The meeting will begin following the Thursday Night Opening Meeting and will continue until 11h00 on Sunday. If you want to volunteer to chair, contact the Program Committee in Madison Avenue Salon II.

Translations

All meetings will be held in English except those indicated as bi-lingual. In addition, simultaneous translations will be available for all meetings held in Times Square throughout the convention. Members may obtain headsets by providing identification. The Translations Committee will have an information board in Columbus Salon I. Members who have volunteered or who wish to volunteer to provide translations should sign-up as soon as possible. Members who need translations not listed on the translation information board should check-in with the committee in Columbus Salon I.

Program

THURSDAY

Time	Topic	Location
13h00	More Will be Revealed	SalonGLM
	Responsibility	SalonCD
	WSB Trustee Forum on Reaching Out to The Oldtimer	Salon E
15h00	“Joie de Vivre” (Joy of Living)	SalonGLM
	The Therapeutic Value...	SalonCD
	The GSR	Salon E
17h00	Higher Power	SalonGLM
	Ready to Go to Any Lengths	Salon E
	Twelve Concepts of Service	SalonCD
	19h00—Opening Meeting—Times Square	
	Sylvia M. (Germany) ❖ James C. (Ireland)	
22h00	Trust	Radio City II,III
	Sharing (Italian/English)	SalonCD
00h00	Compassion	Radio City II,III

FRIDAY

Time	Topic	Location
09h00	Conscious Contact Progression not Perfection The Group	Times Square SalonGLM Salon E
11h00	Balance Tools of the Program Tradition 1, 2, & 3 Spiritual Growth Service in NA	Times Square SalonGLM Radio City II,III SalonCD Salon E
13h00	Sponsorship Feelings God of Our Understanding Hope, Faith & Commitment (Hebrew/English) History of NA in Europe	Times Square SalonGLM Radio City II,III SalonCD Salon E
15h00	Steps 1, 2, & 3 Awareness, Acceptance, Action Dealing with Anger Clean and Serene Public Information	Times Square SalonGLM Radio City II,III SalonCD Salon E
17h00	We do Recover Welcome to the Newcomer Spiritual Awakening Unconditional Love (Portuguese/English) Hospitals & Institutions	Times Square SalonGLM Radio City II,III SalonCD Salon E

19h00—Main Meeting—Times Square

Algera T. (USA) ❖ David O. (Australia)

22h00	Humility Never Alone (German/English)	Radio City II,III SalonCD
00h00	Sexuality	Radio City II,III

SATURDAY

Time	Topic	Location
10h30	In Times Of Illness Grieving Staying in Recovery Three Spiritual Principles (Swedish/English) WSB Trustee Open Forum	Times Square SalonGLM Radio City II,III SalonCD Salon E
12h30	Steps 4, 5, 6, & 7 Just for Today Intimacy Prayer WSB Trustee Forum on HIV	Times Square SalonGLM Radio City II,III SalonCD Salon E
14h30	Forgiveness Recovery and Relapse Traditions 4, 5, & 6 Steps 8 & 9 WSB Trustee Forum on Prejudice	Times Square SalonGLM Radio City II,III SalonCD Salon E
16h30	Gratitude Steps 10, 11, & 12 Letting Go Keep Coming Back (French/English) WSB Trustee Forum on Changing the Steps & Traditions	Times Square SalonGLM Radio City II,III SalonCD Salon E

19h30—UNITY DAY CELEBRATION & MAIN MEETING**Times Square**

Jean-Pierre (France)

22h00	Traditions 7, 8, & 9 Self Esteem	Radio City II,III SalonCD
00h00	Life on Life's Terms	Radio City II,III

SUNDAY

Time	Topic	Location
9h00	Traditions 10, 11, & 12 Changes <i>(Spanish or Greek/English)</i>	Times Square SalonCD

UNE NOUVELLE VISION DE LA VIE A NEW VISION OF LIFE

Closing Meeting and Countdown

Times Square
11h00 – 13h00

Speakers from around the World

Speaker Tapes

A taping vendor has been contracted to provide speaker tapes as a service to convention attendees. All workshops, up to and including the main speaker meetings will be taped. Workshops held after the main speaker meetings will not be available on tape.

Tapes will be available for sale at the New York Convention Centre in Columbus Salon I.

Thursday	10h00 — 13h00; 15h00 — 19h00; 21h00 — 22h00
Friday	10h00 — 13h00; 15h00 — 19h00; 21h00 — 22h00
Saturday	10h00 — 13h00; 15h00 — 19h00
Sunday	10h00 — 15h00

The World Convention Corporation is not benefiting financially in any way from the sale of speaker tapes at WCNA-25.

Entertainment and Events

All activities, except meetings and workshops, require registration and/or a ticket. You must wear a registration badge to be admitted to the dances. The Boat Cruise, Dinner, and Chateau Party all require tickets. We are not responsible for the replacement of lost registration badges or event tickets. There will be no refunds on paid event tickets.

Bus transportation to the Friday Boat Cruise will depart from the front of the New York Convention Centre immediately following the Main Meeting. All buses will be departed no later than 21h30.

Bus transportation to the Saturday Chateau Party & Fireworks Display will depart from the front of the New York Convention Centre immediately following the Main Meeting. Buses will depart promptly at the time printed on your ticket. Return buses back to the convention centre will begin running at 01h00 and continue every 30 minutes. The last bus will depart at 03h00.

Day	Event	Location	Time
Thursday	Dance	Convention Centre, Salon HJK	22h00 — 02h00
Friday	Talent Show	Convention Centre, Salon HJK	21h00 — 22h00
	Dance	Convention Centre Salon HJK	22h00 — 02h00
	Boat Cruise	River Seine, Paris	23h30 — 01h30
Saturday	Dinner	Hotel Cheyenne	14h00 — 17h00
	Dance	Convention Centre, Salon HJK	22h00 — 02h00
	Chateau Party & Fireworks Display	Le Chateau Royal Du Vivier Fontenay-Tresigny, France	23h00 — 03h00

Thank you...

...to all those people who offered their services to make this very unique and special convention a success.

Finally, a very personal heartfelt thanks goes out to each member of the Paris Host Committee for their hours and hours of selfless service in the planning of WCNA-25.

An Open Invitation

You are invited to join the World-wide NA Community in a Celebration of Recovery and Unity at WCNA-26 to be held in St. Louis, Missouri, USA on 29 August - 1 September 1996

You can register early for WCNA-26 on Saturday and Sunday. Times and location to be announced.

THE TWELVE TRADITIONS OF NARCOTICS ANONYMOUS

1. Our common welfare should come first; personal recovery depends on NA unity.
2. For our group purpose there is but one ultimate authority—a loving God as He may express Himself in our group conscience. Our leaders are but trusted servants, they do not govern.
3. The only requirement for membership is a desire to stop using.
4. Each group should be autonomous except in matters affecting other groups or NA as a whole.
5. Each group has but one primary purpose—to carry the message to the addict who still suffers.
6. An NA group ought never endorse, finance, or lend the NA name to any related facility or outside enterprise, lest problems of money, property and prestige divert us from our primary purpose.
7. Every NA group ought to be fully self-supporting, declining outside contributions.
8. Narcotics Anonymous should remain forever non-professional, but our service centers may employ special workers.
9. NA, as such, ought never be organized, but we may create service boards or committees directly responsible to those they serve.
10. Narcotics Anonymous has no opinion on outside issues; hence the NA name ought never be drawn into public controversy.
11. Our public relations policy is based on attraction rather than promotion; we need always maintain personal anonymity at the level of press, radio, and films.
12. Anonymity is the spiritual foundation of all our traditions, ever reminding us to place principles before personalities.

Twelve Traditions reprinted for adaptation by permission of AA World Services, Inc.

Just for Today

TELL YOURSELF:

JUST FOR TODAY my thoughts will be on my recovery, living and enjoying life without the use of drugs.

JUST FOR TODAY I will have faith in someone in NA who believes in me and wants to help me in my recovery.

JUST FOR TODAY I will have a program. I will try to follow it to the best of my ability.

JUST FOR TODAY through NA I will try to get a better perspective on my life.

JUST FOR TODAY I will be unafraid, my thoughts will be on my new associations, people who are not using and who have found a new way of life. So long as I follow that way, I have nothing to fear.

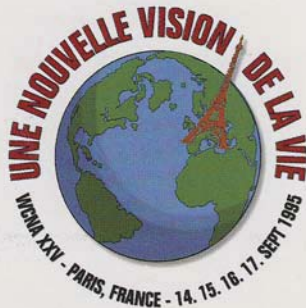



INSTANT AUDIO CASSETTES



WCNA 25

14th - 17th September 1995

DISNEYLAND, PARIS

WCNA 25

is being recorded by QED RECORDING SERVICES LTD

Audio cassettes are available for purchase *immediately* after each session from the QED Sales Desk.

QED conference cassettes reduce the need for copious note-taking and allow you to concentrate fully on the proceedings. Cassettes can be conveniently listened to at work, home or in the car and are an ideal way of assimilating and disseminating information. Cassettes are usually recorded on both sides, so please turn over the tapes, without re-winding, to continue the programme.

Take advantage of the discount prices by purchasing your tapes at the Conference. Tapes can also be purchased after the event by completing the mail order form on the reverse of this leaflet or by phoning QED on +44 (0)181 441 7722.

PRICES FOR TAPES

(ONLY APPLICABLE TO TAPES PURCHASED AT THE CONFERENCE)

FF50 per tape



DISCOUNTS (only applicable at the Convention)

Free tape for every 7 tapes purchased (& free presentation case)

COMPLETE SET OF TAPES

FF2250 including free presentation cases

For ordering by mail, please use order form on the back page

Thursday 14th September

- Tape 1** More Will Be Revealed
- Tape 2** Responsibility
- Tape 3** WSB Trustee Forum on Reaching Out to the Oldtimer
- Tape 4** "Joie de Vivre" (Joy of Living)
- Tape 5** The Therapeutic Value...
- Tape 6** The GSR
- Tape 7** Higher Power
- Tape 8** NA: A Worldwide Fellowship
- Tape 9** Sharing
- Tape 10** 12 Concepts of Service
- Tape 11** **Opening Meeting**

Friday 15th September

- Tape 12** Conscious Contact
- Tape 13** Progression not Perfection
- Tape 14** Balance
- Tape 15** Tools of the Program
- Tape 16** Traditions 1, 2 & 3
- Tape 17** Spiritual Growth
- Tape 18** Service in NA

- Tape 19** Sponsorship
- Tape 20** Feelings
- Tape 21** God of our Understanding
- Tape 22** Hope, Faith and Commitment
- Tape 23** History of NA in Europe
- Tape 24** Steps 1, 2 & 3
- Tape 25** Awareness, Acceptance, Action
- Tape 26** Dealing with Anger
- Tape 27** Clean and Serene
- Tape 28** Public Information
- Tape 29** We do Recover
- Tape 30** Welcome to the Newcomer
- Tape 31** Spiritual Awakening
- Tape 32** Unconditional Love
- Tape 33** Hospitals & Institutions
- Tape 34** **Main Meeting**

Saturday 16th September

- Tape 35** In Times Of Illness
- Tape 36** Grieving
- Tape 37** Staying in Recovery
- Tape 38** 3 Spiritual Principles

- Tape 39** WSB Trustee Open Forum
- Tape 40** Steps 4, 5, 6 & 7
- Tape 41** Just for Today
- Tape 42** Intimacy
- Tape 43** Prayer
- Tape 44** WSB Trustee Forum on HIV
- Tape 45** Forgiveness
- Tape 46** Recovery and Relapse
- Tape 47** Traditions 4, 5 & 6
- Tape 48** Steps 8 & 9
- Tape 49** WSB Trustee Forum on Prejudice
- Tape 50** Gratitude
- Tape 51** Steps 10, 11 & 12
- Tape 52** Letting Go
- Tape 53** Keep Coming Back
- Tape 54** WSB Trustee Forum on Changing the Steps and Traditions
- Tape 55** **Unity Day Celebration and Main Meeting**

Sunday 17th September

- Tapes 56 and 57** **A New Vision of Life - Closing Meeting**
(2 tapes)

MAIL ORDER FORM

Audio cassettes of **WCNA 25** are available for purchase from the QED sales desk *immediately* after each session at the discount prices detailed inside. However, if you wish to order by mail, please complete the order form below and send together with payment to: QED Recording Services Ltd. Lancaster Road, New Barnet, Herts, EN4 8AS U.K.
Tel: +44 (0)181 441 7722 Fax: +44 (0)181 441 0777

Name & Address.....
.....
.....
.....

Tel:..... Fax:.....

Please send tape nos:.....
.....
.....

MAIL ORDER PRICES (inc p&p): For on-site prices see inside

FF60 (UK £7.50) per tape

FF2750 (UK £350.00) Complete set of tapes (in presentation cases)

TOTAL: £

Please make UK cheques payable to **QED RECORDING SERVICES LTD**

Please make French cheques payable to **QED SERVICE**

PAYMENT BY CREDIT CARD

Please charge against my Visa Mastercard Amex

Card No.....

Cardholder name and address (if different from above)
.....
.....
.....

Signature..... Expiry Date

QED RECORDING SERVICES LTD, Lancaster Road, New Barnet, Herts. EN4 8AS, UK
Tel: +44 (0)181 441 7722 Fax: +44 (0)181 441 0777

TOURISTIC INFORMATION



A NEW VISION OF LIFE
WCNA XXV

PARIS INFORMATION

• If you're unable to find a piece of information in this guide please go to the Convention Information Stand. Have a great convention !

Be sure your passport is valid.

• If you lose your passport, or if it is stolen, make an official report in any police station.

You can also report the loss to the consulate of your country.

• Here is a list of the telephone numbers of some of the consulates in Paris :

United states : 40.20.01.99
Italy : 45.20.06.06
Great Britain : 42.66.06.68
Portugal : 44.06.88.90
Spain : 47.66.06.68
germany : 42.99.78.00

• In case of a medical emergency call : 18 (from any telephone booth, or (2) SOS-Medecins, 47.07.77.77 or 43.37.77.77

For telephone information call : 12

For the police : 17

COMMUNICATION

To send mail use the mail boxes and the post offices, which you can recognize by the yellow sign "LA POSTE". The post office called "LA POSTE DU LOUVRE" (on the rue du Louvre) is open 24 hrs-a-day, 7 days-a-week.

In most telephone booths you must use a telephone card which you can buy in tabacs, at the postoffice or sometimes in the metro. There are two types of telephone cards : one for 40 francs (50 units) and another for 90 francs (120 units). To call outside of France, dial 19, followed by the country code (United States = 1 + area code, Portugal = 351 + area code, Germany = 49 + area code, Italy = 39 + area code, Spain = 34 + area code). After 21:30 (9:30 pm) calls are half the daytime price

AMUSEMENTS

Foreign films are often shown in their original language version with french subtitles. If this is the case it is indicated by "V.O" (version originale). The price of a cinema is usually between 40 and 50 francs. For amusement and cultural activities (museum, monuments, theater, opera, art exhibitions, movies, discoteques, buy "Pariscope", a 3-franc guide on sale in magazine stands. It comes out on wednesday, which is the day that new films come out. There is an English-language section in Pariscope.

Most museums are closed on Tuesdays. The Office of Tourism is located at : 127 avenue des Champs Elysee (tel: 49.52.53.54).

Metro: Charles de Gaule-Etoile. There you can find guides, detailed maps and all sorts of other tourist information in several language.

RESTAURANTS

the price of drinks in cafes are different depending whether you stand at the counter (least expensive), sit in the cafe (more expensive), or sit outside on the terrasse (most expensive). The big cafes on the major boulevards are more expensive than the little cafes on side streets.

In cafes and restaurants, service is included in the bill. An appropriate tip is between 5 and 10 percent of the bill.

TRANSPORTATION

The metro and the RER stop running at about 12:30 am (0:30). You can ask for a metro map in any station metro.

The Paris-Disneyland connection is on the RER ("Marne-la-vallee" station for Disneyland). The trip costs about 75 francs round-trip. The last train leaves Paris at about midnight and the first train leaves at about 5:30 am. By taxi the trip costs about 300 francs one-way (maximum 3 person).

At the train station or at the "Disneyland" bus, there is a bus service which will take you to your hotel. It's simple and practical. There are 12 500 taxis in Paris. You can get a taxi by calling different phone numbers (compagnie G7: 47.39.33.33 or 47.39.47.39). If you call a cab the meter starts running from the moment the call is received. In the streets taxi stations are indicated by a sign "TAXI". Taxis can stop in the streets if the lighted sign on the roof of the cab is lit. Normal tips for a taxi are between 7 and 10 percent of the total on the meter. Taxis in Paris almost never accept more than 3 riders. Also, try to have change instead of just big bills.



SHOPPING

The prices marked on products in stores are generally including tax (TTC = toutes taxes comprises). If a price is given HT (hors taxe = not including tax), you must add 20,6% to the price.

In Paris there are Duty-Free shops where you can buy certain products (such as perfumes) without paying tax.

MONEY

The currency used in France and at the world convention is the French Franc. All merchandise sold at the convention has to be paid for in French francs. Make sure that you have changed your money before coming to France or upon arriving. There are exchange offices in international airports and in most central neighborhoods in Paris.

The following banks have exchange office:
115 Champs-elysee - 75008 Paris - tel: 40.70.27.22 or 40.70.77.17 Open every day between 8:30 am and 8:00 pm (8:30 - 20). There is currency exchange machine available 24 hours-a-day.

2 carrefour de l'Odeon - 75006 Paris - tel: 43.26.20.63

Open from Monday to Saturday from 9 am to 7:30 pm (9-19:30). A currency exchange machine is available 24 hours-a-day.

SOME NICE PLACES IN PARIS ...

La Samaritaine

19, rue de la Monnaie 75001. Metro Louvre-Rivoli. Tel: 40.41.20.20

L'Institut du Monde Arabe

1, rue des fosses-st-Bernard 75005. Metro Jussieu; Tel: 40.51.38.38

Salon de thé de la mosquée de Paris

39 rue Geoffroy-st-hilaire 75005. Métro Monge. Tel: 43.31.18.14

Musée Rodin

Rue de Varenne 75007. Metro Varenne. Tel: 47.05.01.34

La belle France

Tour Eiffel 1st floor. Metro Bir-Hakeim. Tel: 45.55.20.04

WCNA HOW TO GET THERE

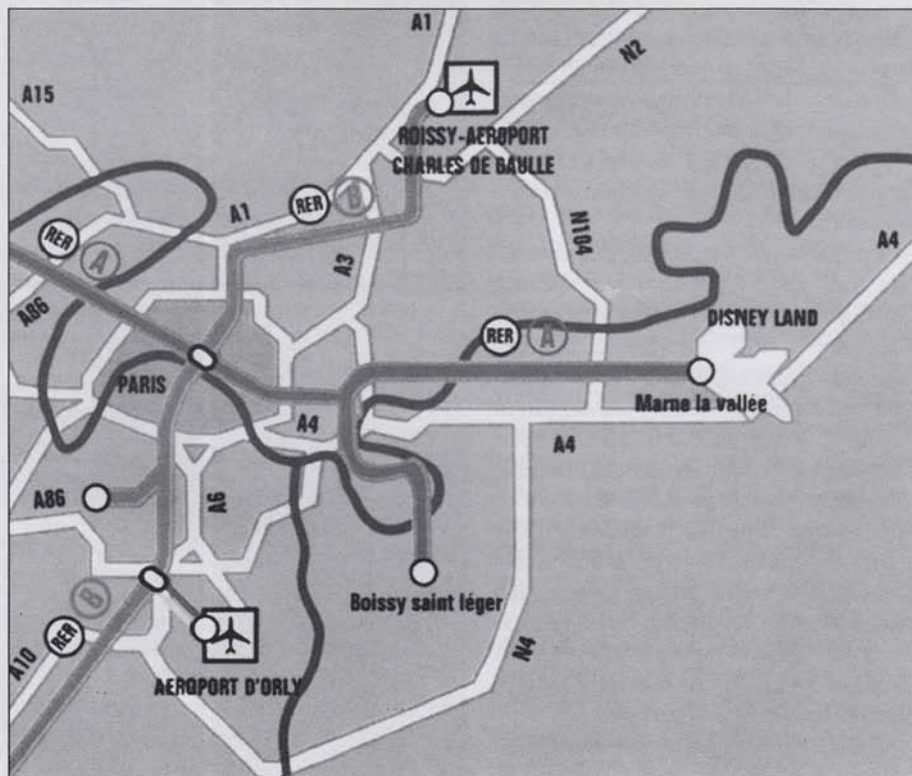



Choisissez une
nouvelle vision
de la vie



WCNA XXV

PARIS, FRANCE

SEPTEMBER 14, 15, 16, 17, 1995



Discount Travel Package

Official discount travel packages are available from the following North American cities through our official travel agency, Travel Smart, Inc.

CITY	*PER PERSON	CITY	*PER PERSON
Montreal	\$1029	Chicago	\$949
Boston	899	Indianapolis	979
Hartford	899	Kansas City	999
New York	899	St. Louis	999
Philadelphia	899	Dallas	999
Wash./Baltimore	899	Houston	999
Pittsburgh	949	San Diego	999
Raleigh	949	Los Angeles	999
Charlotte	949	San Francisco	999
Atlanta	949	Albuquerque	1079
Orlando	949	Denver	1079
Miami	949	Las Vegas	1079
New Orleans	999	Seattle	1099
Nashville	999	Toronto	1199
Cincinnati	949	Calgary	1429
Cleveland	949	Edmonton	1429
Detroit	949	Vancouver	1429
Minneapolis	979		

*Based on midweek/weekend prices.
For round trip weekend travel, add \$20.00 US.

These packages include: round trip air transportation on US Air or Air France; 5 days/4 nights accommodations (based on double occupancy) at the headquarters, Hotel New York in Disneyland Paris; shuttle service between the Paris Airport and Disneyland Paris; and all taxes. All packages are priced per person and based on availability. Connecting flights from other cities are available for an additional charge.

All travel must occur between 8 September and 22 September in order to get the discount airfare. If you would like to stay longer than five days at the Hotel New York, add \$66.00 US per day to the cost of the package. If you would like to stay additional days at another hotel in Paris, Travel Smart Inc. can assist you with your plans.

While there is no deadline on reservations, we suggest that you book your package early, preferably by 15 April 1995.



For more information and booking, call Travel Smart, Inc. at (800) 278-3113 in the US or (619) 278-3113 outside the US. Their normal business hours are Monday thru Friday, 8AM to 5PM Pacific Standard Time.

Gai Paris

WCNA XXV



**Roissy-Airport
Charles-de-Gaulle**

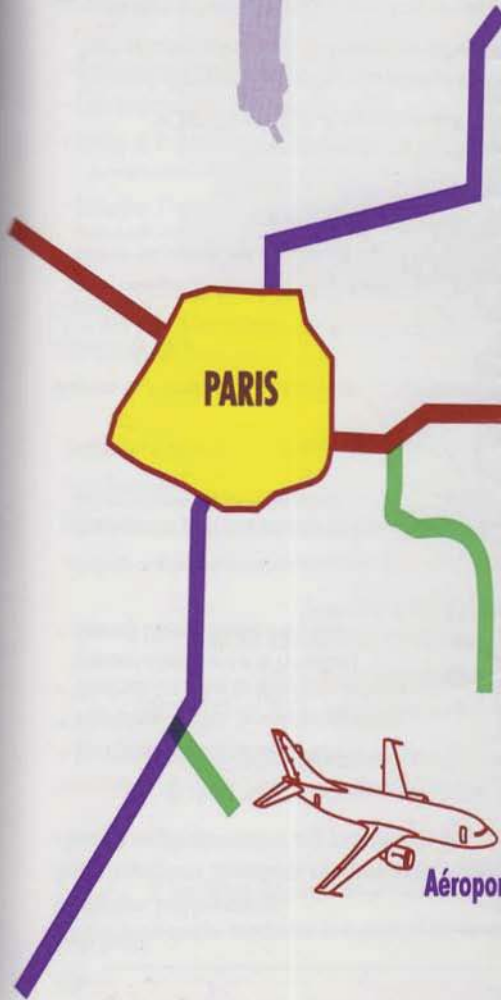

PARIS

RER Train #A4

**Disneyland
Paris**

Marne-La Vallée

Boissy-St.-Léger



Aéroport d'Orly

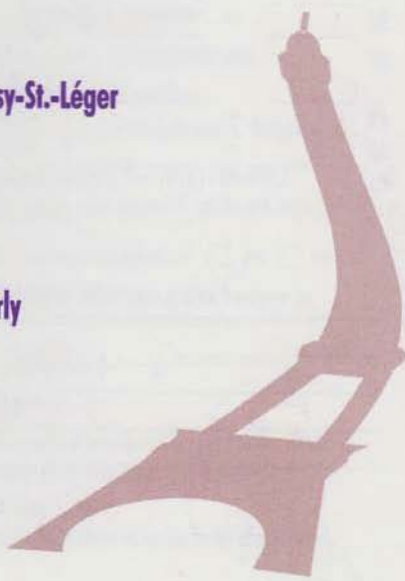

Come and see Paris,
the most beautiful city in the World!
"Gai Paris", city of romance and love.
Don't miss the magnificent Eiffel Tower
by night lit up in all its splendor,
the cancan dancers at the Moulin Rouge
and the painters of the Butte Montmartre.
Walk down the Champs-Elysées!
Relax at a sidewalk cafe on the banks of the
River Seine while admiring the
French architecture and sculptures.
The cultural, culinary and fashion center
of the world will provide an exciting setting
for the First World Convention
held in Continental Europe.
Come and get a real taste of recovery
with a French flavor.



Gai Paris

Venez découvrir Paris,
la plus belle ville du monde. C'est le «gai Paris»,
la ville de la romance et de l'amour.
Ne manquez pas la si célèbre tour Eiffel parée de
son habit de lumière, les danseuses de
french cancan au Moulin Rouge
et les peintres de la Butte Montmartre.
Descendez le long des Champs-Elysées!
Détendez-vous à une terrasse des bords
de Seine en admirant les fastes de l'architecture
française. Capitale internationale de la culture,
de la gastronomie, et de la mode,
Paris sera l'endroit idéal pour la première
Convention Mondiale en Europe continentale.
Venez déguster le rétablissement avec
la saveur d'un parfum français.



Infos Voyage

- **La monnaie officielle en France est le Franc.** Le cours du dollar et du Franc est régulièrement imprimé dans les journaux dans la section affaire.
- **Paris est desservi par deux aéroports :** Roissy-Charles de Gaulle et Roissy.
- Pour tout les citoyens non Européens un passeport en de cours validité est exigé.
- **Navettes Aéroports** départ toutes les 45 mn de Roissy et Orly pour Eurodisney. Environ FF75,00.
- **Train** (RER de Paris/Châtelet les Halles à Disneyland Paris) : ligne A4, direction Marne-la-Vallée. Départ toutes les 16 mn. Durée du trajet environ 40 mn. Dernier train au départ de Paris : 0 h35. Dernier train au départ de Disneyland Paris : 0 h22. Environ FF 37,00 aller simple. Forfait 3 jours : FF 200,00 (nombre de voyages illimité).
- **Taxi** de Paris au parc Eurodisney, environ FF400,00.
- **Location de Voiture :** se renseigner dans les aéroports ou auprès de votre agence de voyage.
- **Parking :** gratuit pour les personnes que résidant dans les hôtels du parc Disneyland Paris. FF20,00 par jour pour les visiteurs.

Formule Spéciale

Le voyage à prix forfaitaire est disponible de Montréal par notre agence de voyage officielle Travel Smart, Inc. Ce forfait comprend un billet d'avion aller/retour avec Air France, cinq jours et quatre nuits à l'Hôtel New York quartier général de la convention (sur la base de deux personnes minimum), navette de l'aéroport à l'hôtel et de l'hôtel à l'aéroport. Prix du forfait: \$1029.00 US. Si vous désirez rester plus de cinq jours à l'hôtel New York, ajouter \$60.00 US par jour supplémentaire au prix du forfait. Si vous désirez prolonger votre séjour à Paris, l'agence de voyage sera heureuse de vous assister. Pour pouvoir bénéficier du prix forfaitaire tout voyage doit avoir lieu entre le 8 Septembre 1995 et le 23 Septembre 1995. Nous vous suggérons de prendre vos réservations avant le 15 Avril 1995. Pour plus d'information et pour réserver, appeler le (619) 278-3113.

Infos Hôtels

- ① **HÔTEL NEW YORK :** sera l'hôtel principal et jouxte le centre de Convention. C'est un hôtel 4 étoiles style art déco situé sur les rives du lac Buena Vista. Chaque chambre est climatisée et possède une télévision couleur et un minibar. Accès gratuit au club de sports, à la piscine et aux courts de tennis.
Prix des chambres FF650,00 par nuit (maximum 4 personnes).
- ② **HÔTEL CHEYENNE :** est un hôtel dans le style des villes du Far West. Il se situe à 10 mn à pied du centre de Convention. Prix des chambres F495,00 par nuit (maximum 4 personnes, 1 double lit & 2 couchettes). NOTER : Toutes les chambres sont payables en Francs Français.
- ③ **HÔTEL SANTA FE :** est un hôtel décoré dans le style nouveau Mexique. Il se situe à 10 mn à pied du centre de Convention. Prix des chambres FF495,00 par nuit (maximum 4 personnes).
- ④ **CAMP DAVY CROCKETT :** bungalows avec cuisine équipée (vaisselle incluse). Le camp se situe au milieu d'une petite forêt, à 15 mn en voiture du centre de Convention. Prix des bungalows FF495,00 par nuit (maximum 6 personnes).

Hôtel Réservation pour WCNA XXV

S'IL VOUS PLAÎT ÉCRIRE LISIBLEMENT

IMPORTANT: Votre réservation doit être reçue **AVANT LE 14 AOÛT 1995**. Les prix ne seront pas nécessairement les mêmes après cette date et seront basés selon la disponibilité. Une confirmation sera envoyée par l'hôtel sélectionné dans la 1ère Partie. Si vous retenez plus d'une chambre, vous pouvez photocopier ce formulaire.



Convention Center

Envoyer à :

Disneyland Paris Vacances

C.R.O. Convention/Service Réservation
BP 132

77777 Marne la Vallée Cedex 4, France

OR FAX TO :

+33 (1) 60-30-50-51

Aucune réservation ne peut se faire par téléphone.

1ère Partie

Nom _____

Adresse _____

Ville _____

Pays _____

Code Postal _____ Téléphone _____

2ème Partie

Sélectionner trois hôtel participants. Inscrivez les noms ci-dessous.

1. _____ 2. _____ 3. _____

Premier Choix

Deuxième Choix

Troisième Choix

Note: Les chambres sont attribuées dans l'ordre dans lequel les réservations sont reçues.

Si votre 1er Choix n'est pas disponible, l'attribution se fera selon la disponibilité de votre 2ème choix etc.

Toutes modifications ou annulations doivent se faire directement avec l'hôtel.

Écrire lisiblement ou imprimer le nom des occupants _____

Date d'arrivée _____ Date de départ _____

Cocher la chambre sélectionner.

Chambres fumeur

Non fumeur

Pour l'hôtel New York uniquement.

Un Double Lit

Deux Double Lits

3ème Partie

Pour chaque réservation il est nécessaire de verser à l'avance une somme égale au prix d'une nuit à l'hôtel de votre choix. Les chèques internationaux sont payables en Francs Français à l'ordre de Euro-Disney Resort.

Ci-joint : _____ FF ou débiter ma AMEX VISA MASTER CARD EURO

CARD CARTE BLEUE

Carte de Crédit _____ Date d'expiration _____

Signature _____



Inscription WCNA XXV

S'IL VOUS PLAÎT ÉCRIVER LISIBLEMENT

Nom _____

Adresse _____

Ville _____ Pays _____

Code Postal _____ Téléphone () _____

Inscriptions Supplémentaires _____

Toutes inscriptions doivent être envoyées avant le 25 Août 1995, après cette date il sera possible de s'inscrire sur place.

Evènement	Prix	Quantité	Total
• Inscription (avant le 1er août 1995)	FF150,00	x _____ =	_____ FF
• Inscription Tardive (avant le 1er août 1995)	FF200,00	x _____ =	_____ FF
• Vendredi Croisière de Minuit sur la Seine (transport aller/retour à et de Paris inclus)	FF100,00	x _____ =	_____ FF
• Samedi Dîner à thème (14h à 17h)	FF125,00	x _____ =	_____ FF
	Don pour le Nouveau	=	_____ FF
	Sub total	=	_____ FF
Laisser-passer pour une journée au Parc Disneyland Paris (Ceci ne fait pas partie de la convention)			
adulte	FF180,00	x _____ =	_____ FF
enfant	FF140,00	x _____ =	_____ FF
	Montant total ci-joint	=	_____ FF

Moyens de Payment Master Card American Express VISA Chèque/Eurochèque**

Numéro de carte* _____ Expiration date _____

Signature _____ Date _____

*Tous les paiements par cartes de crédit sont débités aux États-Unis et peuvent être soumis à des taxes supplémentaires.

**Adressez tout paiement par chèque à l'ordre de World Convention Corporation

Si vous demeurez aux États-Unis/Amerique Centrale/Amerique du Sud envoyer à :

WCNA XXV c/o WSO, PO Box 9999, Van Nuys, California 91409-9999 USA

Si vous demeurez en Europe/Afrique/Middle East/Asie envoyer à :

WCNA XXV c/o WSO—Europe Avenue Winston Churchill, Laan 249/B15, Brussels, Belgium

Pour plus d'informations sur les inscriptions, appelez le : (818) 780 3951/Fax (818)785-0923

Pour contacter le Comité de la Convention à Paris, appelez le : +33 (1) 40-86-09-36

La convention se tiendra en Anglais avec traductions

• Avez-vous besoin d'une traduction ? Oui Non • Quelles langue parlez-vous ?

• Si vous avez des besoins spécifiques dus à un handicap, merci de l'indiquer : _____

Infos Programme

Si vous desirez donner une experience dans une réunion :

• Conférenciers Principaux : 5 ans d'abstinence

• Conférenciers Ateliers : 3 ans d'abstinence

Envoyez vos cassettes à : WCNA XXV Program Committee

PO Box 9999, Van Nuys, CA 91409-9999 USA

Date limite d'envoi des cassettes : jusqu'au 1er avril 1995.

Joignez le nom, adresse et numéro de téléphone du conférencier avec votre envoi.

Si vous désirez prendre du service :

Nom du volontaire: _____ Tél : _____



Travel Information

- **The official currency in France is the Franc.** As of January 1, 1995, One US Dollar was worth approximately five French Francs. We have used this figure to give you approximate prices in US Dollars. However, the currency exchange rate may change at any time. Current exchange rates are printed regularly in the business section of most daily newspapers.
- **Paris is served by two airports:** Roissy-Charles de Gaulle and Orly.
- **A valid Passport** is required for all non-European citizens entering France.
- **Airport Shuttles** leave from both airports every 45 min. for Disneyland Paris. Approximately FF75,00 (\$15.00US).
- **Train (RER from Paris/Chatelet-Les Halles to Disneyland Paris):** Line A4, direction Marne-La-Vallée. The trip takes approximately 40 min. and leaves every 16 min. The last train from Paris to Disneyland Paris is at 0h35 am (12:35am) and the last train from Disneyland Paris to Paris is at 0h22 am (12:22am). Approximately FF 37,00 (\$7.50US) one way. Three day travel Pass FF200,00 (\$40.00US).
- **Taxi:** From Paris to Disneyland Paris, approximately FF400,00 (\$80.00US).
- **Rent A Car:** For the best rates, contact travel or car rental agencies prior to departure.
- **Parking** is free for hotels residents and FF20,00 (\$4.00US) per day for visitors.

Official Discount Travel Package

Official discount travel packages are available from most North American cities through our official travel agency for this convention, Travel Smart, Inc. These packages should be booked early due to limited availability. The packages include round-trip air transportation on US Air or Air France, 5 days/4 nights accommodations (based on double occupancy) at the headquarters Hotel New York, shuttle service to and from the airport, and all taxes.

For more information, see back panel of this flyer.

Travel Smart, Inc. can be reached at (800) 278-3113/(619) 278-3113.

Hotel Information

Note: All rooms are payable in French Francs. US rates are approximated.

- 1 **New York Hotel** — This will be the headquarters hotel and is adjacent to the Convention Center. It is a luxury art deco styled hotel which is situated on the shores of lake Buena Vista. Each room is air-conditioned and equipped with color television and mini-bar. Services included: health club, indoor/outdoor pools, tennis courts. Rates: FF650,00/\$130.00US per night (up to 4 people in one king or two double beds).
- 2 **Hotel Cheyenne** — This casual hotel is furnished and themed in the style of a wild west American town and is a 10 min. walk from the Convention center. Rates: FF495,00/\$95.00US per night (all rooms sleep up to 4 people in 1 double bed & 2 bunk beds).
- 3 **Hotel Santa Fe** — This hotel is decorated in New Mexico style and is a 10 min. walk from the Convention Center. Rates: FF495,00/\$95.00US per night (all rooms sleep up to 4 people in two double beds).
- 4 **David Crockett Ranch** — A 10 min. drive by automobile from the Convention Center, these bungalows, equipped with full kitchens including pots and pans and a microwave, are located in the middle of a small forest. Rates: FF495,00/\$95.00US per night (all cabins sleep up to 6 people in 2 double beds & 2 bunk beds).

Hotel Reservation for WCNA XXV

PLEASE PRINT ALL INFORMATION CLEARLY

IMPORTANT NOTE: Your reservation must be received **BEFORE THE AUGUST 14, 1995** cut-off date. Convention rates may not apply after above cut-off date and will be based on availability. Confirmation will be sent by the hotel to the individual named in Part I. If more than one room is required, this form may be photocopied. **Persons purchasing a discount travel package must send this form to Travel Smart, Inc.**

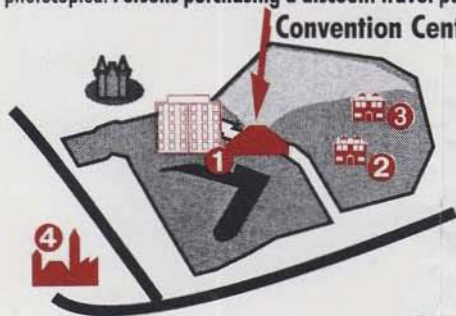

Send to:

Disneyland Paris Vacances

C.R.O. Convention/Service Reservation

BP 132

77777 Marne la Vallée Cedex 4, France

OR FAX TO:

+33 (1) 60-30-50-51

No telephone reservations will be accepted.

Part I

Name _____
Address _____
City/State _____
Country _____ Zip _____
Area Code () Phone Number _____

Part II

Select up to three choices from participating hotels. Enter names below.

1. _____ 2. _____ 3. _____
First Choice Second Choice Third Choice

Note: Rooms are assigned in date order received. If your first choice is not available, assignment will be made at next available choice. Changes and cancellations must be made directly with hotel.

Print or type names of occupants. _____ , _____
_____ , _____ , _____

Arrival date _____ Departure date _____

For all hotels, indicate: Smoking Non Smoking

For Hotel New York only, indicate: Single King/Queen Bed Two Queen/Double Beds

Part III

An advance deposit equivalent to one night's stay at the hotel of your choice is required for each room. Forms will be returned to sender if received without deposit. Checks must be payable in French Francs and made out to Disneyland Paris. Bank checks payable in French Francs are available at most commercial banks.

Enclosed: _____ FF or charge my: AMEX VISA MASTERCARD EUROCARD CARTE BLEUE

Charge Card # _____ Expiration date _____

Signature _____

WCNA XXV Registration

PLEASE PRINT ALL INFORMATION CLEARLY

Name _____

Address _____

City _____ Province/State/Country _____

Zip Code/Postal _____ Telephone() _____

Additional Registrants _____

All registrations must be mailed by August 25, 1995, after which on-site registrations will be accepted.

Event	Price	Quantity	Total
• Registration (before August 1st, 1995)	\$30.00	x _____ = \$ _____	
• Late Registration (after August 1st, 1995)	\$40.00	x _____ = \$ _____	
• Friday Midnight Boat Cruise on the River Seine in Paris (transportation to and from Paris included; limited tickets available)	\$20.00	x _____ = \$ _____	
• Saturday Theme Dinner (approx. 2:00 PM-5:00PM) (limited tickets available)	\$25.00	x _____ = \$ _____	
	Newcomer Donation	= \$ _____	
	Sub total	= \$ _____	
One day pass discount pass to Disneyland Paris: Adult	\$36.00	x _____ = \$ _____	
(Not an organized convention event)	Child	\$28.00 x _____ = \$ _____	
	Total Amount Enclosed	= \$ _____	

PRE-REGISTERED

Method of payment: Master Card American Express VISA Check/Money Order**

Card Number* _____ Expiration Date _____

Signature _____ Date _____

*All credit card payments are processed in the U.S.A. and may include a service charge. **Must be made payable to WCNA XXV.

If you live in North/Central/South America mail to:
WCNA XXV c/o WSO, PO Box 9999, Van Nuys, California 91409-9999 USA

If you live in Europe/Africa/Middle East/Asia Pacific mail to:
WCNA XXV c/o WSO—Europe Avenue Winston Churchill, Laan 249/B15, Brussels, Belgium

For all registration information, please call: (818) 780-3951/Fax (818) 785-0923
To speak with the Convention Committee in Paris, please call +33 (1) 40-86-09-36

• The Convention will be held in English • Do you need translation? yes no

If yes, What language do you speak? _____

If you have special needs due to a physical challenge, please specify: _____

Programming Information

Wish to speak? • Main Speakers: 5 years clean time • Workshop Speakers: 3 years clean time
Send tapes to: WCNA XXV Program Committee, PO Box 9999, Van Nuys, CA 91409-9999 USA
Tape deadline extended to May 1, 1995.

Tapes must include name, address, and phone number of speaker in order to be considered.

Anyone wishing to volunteer for the convention:

Volunteer's Name _____ Tel. () _____